

<b>Adaptors</b>			
PART NUMBER	DESCRIPTION	UNIT	LIST PRICE
<b>BSP M - BSP M – Straight</b>			
1B-02	1/8 BSPP M X 1/8 BSPP M	EA	R17.05
1B-02-04	1/8 BSPP M X 1/4 BSPP M	EA	R14.73
1B-02-06	1/8 BSPP M X 3/8 BSPP M	EA	R19.82
1B-02-08	1/8 BSPP M X 1/2 BSPP M	EA	R29.66
1B-04	1/4 BSPP M X 1/4 BSPP M	EA	R16.44
1B-04-06	1/4 BSPP M X 3/8 BSPP M	EA	R22.28
1B-04-08	1/4 BSPP M X 1/2 BSPP M	EA	R33.37
1B-06	3/8 BSPP M X 3/8 BSPP M	EA	R24.24
1B-06-08	3/8 BSPP M X 1/2 BSPP M	EA	R31.04
1B-06-12	3/8 BSPP M X 3/4 BSPP M	EA	R43.34
1B-08	1/2 BSPP M X 1/2 BSPP M	EA	R36.44
1B-08-10	1/2 BSPP M X 5/8 BSPP M	EA	R36.39
1B-08-12	1/2 BSPP M X 3/4 BSPP M	EA	R47.00
1B-08-16	1/2 BSPP M X 1 BSPP M	EA	R68.64
1B-10	5/8 BSPP M X 5/8 BSPP M	EA	R43.08
1B-10-12	5/8 BSPP M X 3/4 BSPP M	EA	R43.34
1B-12	3/4 BSPP M X 3/4 BSPP M	EA	R47.64
1B-12-16	3/4 BSPP M X 1 BSPP M	EA	R84.91
1B-12-20	3/4 BSPP M X 1 1/4 BSPP M	EA	R119.69
1B-16	1 BSPP M X 1 BSPP M	EA	R83.01
1B-16-20	1 BSPP M X 1 1/4 BSPP M	EA	R134.53
1B-16-24	1 BSPP M X 1 1/2 BSPP M	EA	R161.30
1B-20	1 1/4 BSPP M X 1 1/4 BSPP M	EA	R131.30
1B-20-24	1 1/4 BSPP M X 1 1/2 BSPP M	EA	R157.61
1B-24	1 1/2 BSPP M X 1 1/2 BSPP M	EA	R181.51
1B-24-32	1 1/2 BSPP M X 2 BSPP M	EA	R279.25
1B-32	2 BSPP M X 2 BSPP M	EA	R294.84
<b>BSP M - BSP M - 90 Degree (Locknut)</b>			
1BG9-04-04	1/4 BSPP M X 1/4 BSPP M 90	EA	R51.48
1BG9-06-06	3/8 BSPP M X 3/8 BSPP M 90	EA	R70.12
1BG9-08-08	1/2 BSPP M X 1/2 BSPP M 90	EA	R104.65
1BG9-12-12	3/4 BSPP M X 3/4 BSPP M 90	EA	R136.28
1BG9-16-16	1 BSPP M X 1 BSPP M 90	EA	R198.20
<b>BSP M - ORFS M – Straight</b>			
1BF-02-04	1/8 BSPP M X 11/16 ORFS M	EA	R17.51
1BF-04	1/4 BSPP M X 9/16 ORFS M	EA	R20.08

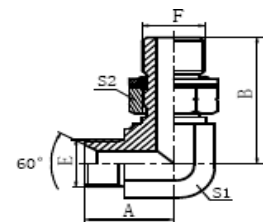

1BF-04-06	1/4 BSPP X 11/16 ORFS M	EA	R22.61
1BF-04-08	1/4 BSPP M X 13/16 ORFS M	EA	R29.68
1BF-06	3/8 BSPP M X 11/16 ORFS M	EA	R36.85
1BF-06-04	3/8 BSPP M X 9/16 ORFS M	EA	R30.15
1BF-06-08	3/8 BSPP M X 13/16 ORFS M	EA	R54.28
1BF-08	1/2 BSPP M X 13/16 ORFS M	EA	R50.28
1BF-08-04	1/2 BSPP M X 9/16 ORFS M	EA	R39.69
1BF-08-06	1/2 BSPP M X 11/16 ORFS M	EA	R39.69
1BF-08-10	1/2 BSPP M X 1-14 ORFS M	EA	R65.78
1BF-08-12	1/2 BSPP M X 1 3/16 ORFS M	EA	R73.73
1BF-12	3/4 BSPP M X 1 3/16 ORFS M	EA	R73.73
1BF-12-08	3/4 BSPP M X 13/16 ORFS M	EA	R100.44
1BF-12-10	3/4 BSPP M X 1-14 ORFS M	EA	R102.12
1BF-12-16	3/4 BSPP M X 1 7/16 ORFS M	EA	R119.64
1BF-16	1 BSPP M X 1 7/16 ORFS M	EA	R172.20
1BF-16-12	1 BSPP M X 1 3/16 ORFS M	EA	R110.68
1BF-16-20	1 BSPP M X 1 11/16 ORFS M	EA	R205.86
1BF-20	1 1/4 BSPP M X 1 11/16 ORFS M	EA	R165.69
1BF-20-16	1 1/4 BSPP M X 1 7/16 ORFS M	EA	R183.26

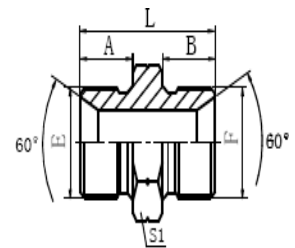
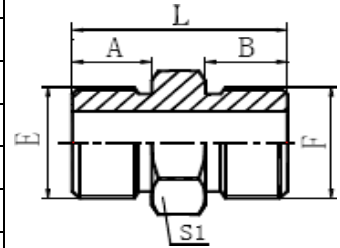

**BSP M - JIC M – Straight**

1BJ-02-04	1/8 BSPP M X 7/16 JIC M	EA	R16.81
1BJ-02-06	1/8 BSPP M X 9/16 JIC M	EA	R23.08
1BJ-04	1/4 BSPP M X 7/16 JIC M	EA	R18.00
1BJ-04-06	1/4 BSPP M X 9/16 JIC M	EA	R24.19
1BJ-04-08	1/4 BSPP M X 3/4-16 JIC M	EA	R27.37
1BJ-06	3/8 BSPP M X 9/16 JIC M	EA	R25.92
1BJ-06-04	3/8 BSPP M X 7/16 JIC M	EA	R22.84
1BJ-06-08	3/8 BSPP M X 3/4-16 JIC M	EA	R28.56
1BJ-06-10	3/8 BSPP M X 7/8 JIC M	EA	R39.45
1BJ-06-12	3/8 BSPP M X 1 1/16 JIC M	EA	R49.58
1BJ-08	1/2 BSPP M X 3/4-16 JIC M	EA	R33.48
1BJ-08-04	1/2 BSPP M X 7/16 JIC M	EA	R29.03
1BJ-08-06	1/2 BSPP M X 9/16 JIC M	EA	R30.91
1BJ-08-10	1/2 BSPP M X 7/8 JIC M	EA	R36.17
1BJ-08-12	1/2 BSPP M X 1 1/16 JIC M	EA	R48.77
1BJ-08-16	1/2 BSPP M X 5/16 JIC M	EA	R72.56
1BJ-10	5/8 BSPP M X 7/8 JIC M	EA	R32.40
1BJ-10-08	5/8 BSPP M X 3/4-16 JIC M	EA	R36.39
1BJ-10-12	5/8 BSPP M X 1 1/16 JIC M	EA	R62.57

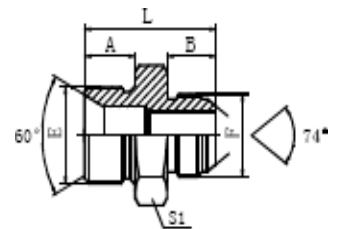

1BJ-12	3/4 BSPP M X 1 1/16 JIC M	EA	R52.08
1BJ-12-06	3/4 BSPP M X 9/16 JIC M	EA	R48.19
1BJ-12-08	3/4 BSPP M X 3/4 -16 JIC M	EA	R56.66
1BJ-12-10	3/4 BSPP M X 7/8 JIC M	EA	R47.61
1BJ-12-16	3/4 BSPP M X 1 5/16 JIC M	EA	R87.47
1BJ-12-20	3/4 BSPP M X 1 5/8 JIC M	EA	R124.66
1BJ-16	1 BSPP M X 1 5/16 JIC M	EA	R91.29
1BJ-16-08	1 BSPP M X 3/4-16 JIC M	EA	R79.92
1BJ-16-12	1 BSPP M X 1 1/16 JIC M	EA	R78.83
1BJ-16-20	1 BSPP M X 1 5/8 JIC M	EA	R126.54
1BJ-16-24	1 BSPP M X 1 7/8 JIC M	EA	R216.27
1BJ-20	1 1/4 BSPP M X 1 5/8 JIC M	EA	R120.59
1BJ-20-12	1 1/4 BSPP M X 1 1/16 JIC M	EA	R130.35
1BJ-20-16	1 1/4 BSPP M X 1 5/16 JIC M	EA	R120.35
1BJ-20-24	1 1/4 BSPP M X 1 7/8 JIC M	EA	R150.02
1BJ-24	1 1/2 BSPP M X 1 7/8 JIC M	EA	R196.20
1BJ-24-16	1 1/2 BSPP M X 1 5/16 JIC M	EA	R173.11
1BJ-24-20	1 1/2 BSPP M X 1 5/8 JIC M	EA	R197.19
1BJ-32	2 BSPP M X 2 1/2 JIC M	EA	R308.41
<b>BSP M - BSPT M – Straight</b>			
1BT-02	1/8 BSPP M X 1/8 BSPT M	EA	R16.42
1BT-02-04	1/8 BSPP M X 1/4 BSPT M	EA	R14.19
1BT-04	1/4 BSPP M X 1/4 BSPT M	EA	R15.41
1BT-04-02	1/4 BSPP M X 1/8 BSPT M	EA	R14.99
1BT-04-06	1/4 BSPP M X 3/8 BSPT M	EA	R19.82
1BT-04-08	1/4 BSPP M X 1/2 BSPT M	EA	R25.54
1BT-06	3/8 BSPP M X 3/8 BSPT M	EA	R18.21
1BT-06-02	3/8 BSPP M X 1/8 BSPT M	EA	R21.95
1BT-06-04	3/8 BSPP M X 1/4 BSPT M	EA	R17.15
1BT-06-08	3/8 BSPP M X 1/2 BSPT M	EA	R27.07
1BT-06-12	3/8 BSPP M X 3/4 BSPT M	EA	R38.44
1BT-08	1/2 BSPP M X 1/2 BSPT M	EA	R35.75
1BT-08-04	1/2 BSPP M X 1/4 BSPT M	EA	R28.69
1BT-08-06	1/2 BSPP M X 3/8 BSPT M	EA	R24.59
1BT-08-12	1/2 BSPP M X 3/4 BSPT M	EA	R43.82
1BT-12	3/4 BSPP M X 3/4 BSPT M	EA	R38.98
1BT-12-06	3/4 BSPP M X 3/8 BSPT M	EA	R74.34
1BT-12-08	3/4 BSPP M X 1/2 BSPT M	EA	R41.80
1BT-12-16	3/4 BSPP M X 1 BSPT M	EA	R80.91

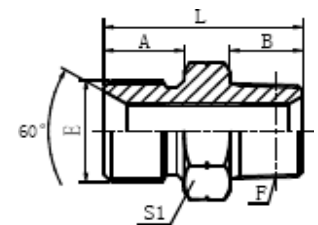

1BT-16	1 BSPP M X 1 BSPT M	EA	R83.54
1BT-16-12	1 BSPP M X 3/4 BSPT M	EA	R81.54
1BT-16-20	1 BSPP M X 1 1/4 BSPT M	EA	R1214.56
1BT-20	1 1/4 BSPP M X 1 1/4 BSPT M	EA	R131.69
1BT-20-16	1 1/4 BSPP M X 1 BSPT M	EA	R143.14
1BT-20-24	1 1/4 BSPP M X 1 1/2 BSPT M	EA	R183.28
1BT-24	1 1/2 BSPP M X 1 1/2 BSPT M	EA	R179.78
1BT-24-20	1 1/2 BSPP M X 1 1/4 BSPT M	EA	R178.89
1BT-32	2 BSPP M X 2 BSPT M	EA	R332.53
<b>ORFS M - ORFS M – Straight</b>			
1F-04	9/16 ORFS M X 9/16 ORFS M	EA	R14.70
1F-04-06	9/16 ORFS M X 11/16 ORFS M	EA	R19.41
1F-04-08	9/16 ORFS M X 13/16 ORFS M	EA	R32.09
1F-06	11/16 ORFS M X 11/16 ORFS M	EA	R19.03
1F-06-08	11/16 ORFS M X 13/16 ORFS M	EA	R31.31
1F-08	13/16 ORFS M X 13/16 ORFS M	EA	R31.28
1F-08-10	13/16 ORFS M X 1-14 ORFS M	EA	R45.39
1F-10	1-14 ORFS M X 1-14 ORFS M	EA	R40.53
1F-10-12	1-14 ORFS M X 1 3/16 ORFS M	EA	R49.73
1F-12	1 3/16 ORFS M X 1 3/16 ORFS M	EA	R54.14
1F-12-16	1 3/16 ORFS M X 1 5/16 ORFS M	EA	R87.00
1F-16	1 7/16 ORFS M X 1 7/16 ORFS M	EA	R77.78
1F-20	1 11/16 ORFS M X 1 11/16 ORFS M	EA	R135.20
1F-24	2-12 ORFS M X 2-12 ORFS M	EA	R165.77
<b>ORFS M - NPT M – Straight</b>			
1FN-04	9/16 ORFS M X 1/4 NPT M	EA	R15.84
1FN-04-02	9/16 ORFS M X 1/8 NPT M	EA	R30.68
1FN-04-06	9/16 ORFS M X 3/8 NPT M	EA	R20.28
1FN-04-08	9/16 ORFS M X 1/2 NPT M	EA	R57.56
1FN-06	11/16 ORFS M X 3/8 NPT M	EA	R23.02
1FN-06-04	11/16 ORFS M X 1/4 NPT M	EA	R29.03
1FN-06-08	11/16 ORFS M X 1/2 NPT M	EA	R26.63
1FN-08	13/16 ORFS M X 1/2 NPT M	EA	R31.12
1FN-08-04	13/16 ORFS M X 1/4 NPT M	EA	R41.06
1FN-08-06	13/16 ORFS M X 3/8 NPT M	EA	R40.66
1FN-08-12	13/16 ORFS M X 3/4 NPT M	EA	R50.07
1FN-10-08	1-14 ORFS M X 1/2 NPT M	EA	R76.30
1FN-10-12	1-14 ORFS M X 3/4 NPT M	EA	R50.07
1FN-12	1 3/16 ORFS M X 3/4 NPT M	EA	R49.28

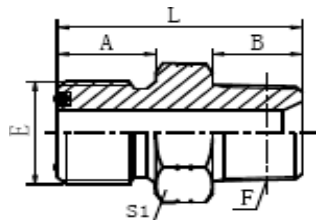
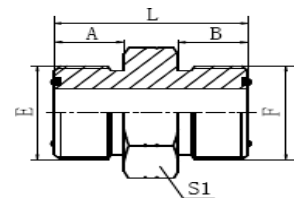

1FN-12-08	1 3/16 ORFS M X 1/2 NPT M	EA	R68.28
1FN-12-16	1 3/16 ORFS M X 1 NPT M	EA	R78.62
1FN-16	1 7/16 ORFS M X 1 NPT M	EA	R81.03
1FN-16-12	1 7/16 ORFS M X 3/4 NPT M	EA	R104.90
1FN-16-20	1 7/16 ORFS M X 1 1/4 NPT M	EA	R175.30
1FN-20	1 11/16 ORFS M X 1 1/4 NPT M	EA	R172.72
1FN-24	2-12 ORFS M X 1 1/2 NPT M	EA	R251.03
<b>ORFS M - SAE M – Straight</b>			
1FO-04	9/16 ORFS M X 7/16 SAE M	EA	R14.94
1FO-04-06	9/16 ORFS M X 9/16 SAE M	EA	R19.75
1FO-04-08	9/16 ORFS M X 3/4-16 SAE M	EA	R31.94
1FO-06	11/16 ORFS M X 9/16 SAE M	EA	R18.80
1FO-06-04	11/16 ORFS M X 7/16 SAE M	EA	R22.23
1FO-06-08	11/16 ORFS M X 3/4-16 SAE M	EA	R28.00
1FO-06-10	11/16 ORFS M X 7/8 SAE M	EA	R41.15
1FO-08	13/16 ORFS M X 3/4-16 SAE M	EA	R29.37
1FO-08-06	13/16 ORFS M X 3/8 SAE M	EA	R31.24
1FO-08-10	13/16 ORFS M X 7/8 SAE M	EA	R41.48
1FO-08-12	13/16 ORFS M X 1/ 1/16 SAE M	EA	R51.15
1FO-10	1-14 ORFS M X 7/8 SAE M	EA	R41.15
1FO-10-08	1-14 ORFS M X 3/4-16 SAE M	EA	R45.72
1FO-10-12	1-14 ORFS M X 1 1/16 SAE M	EA	R49.86
1FO-12	1 3/16 ORFS M X 1 1/16 SAE M	EA	R56.83
1FO-12-08	1 3/16 ORFS M X 3/4-16 SAE M	EA	R65.81
1FO-12-16	1 3/16 ORFS M X 1 5/16 SAE M	EA	R87.00
1FO-16	1 7/16 ORFS M X 1 5/16 SAE M	EA	R83.05
1FO-16-12	1 7/16 ORFS M X 1 1/16 SAE M	EA	R99.42
1FO-16-20	1 7/16 ORFS M X 1 5/8 SAE M	EA	R129.31
1FO-20	1 11/16 ORFS M X 1 5/8 SAE M	EA	R131.25
<b>ORFS M - SAE M - 90 Degree</b>			
1FO9-04	9/16 ORFS M X 7/16 SAE M 90	EA	R59.44
1FO9-04-06	9/16 ORFS M X 9/16 SAE M 90	EA	R89.57
1FO9-06	11/16 ORFS M X 9/16 SAE M 90	EA	R83.59
1FO9-06-04	11/16 ORFS M X 7/16 SAE M 90	EA	R113.25
1FO9-06-08	11/16 ORFS M X 3/4-16 SAE M 90	EA	R104.91
1FO9-08	13/16 ORFS M X 3/4-16 SAE M 90	EA	R89.44
1FO9-08-06	13/16 ORFS M X 9/16 SAE M 90	EA	R141.04
1FO9-08-10	13/16 ORFS M X 7/8 SAE M 90	EA	R150.10
1FO9-08-12	13/16 ORFS M X 1 1/16 SAE M 90	EA	R184.32

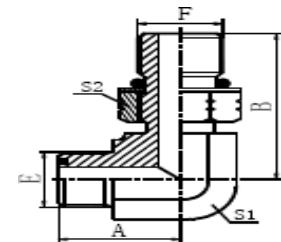
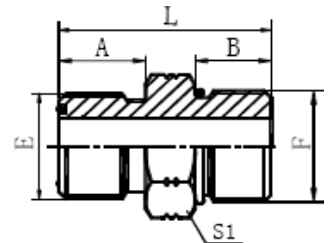

1FO9-10	1-14 ORFS M X 7/8 SAE M 90	EA	R146.89
1FO9-10-08	1-14 ORFS M X 3/4-16 SAE M 90	EA	R171.60
1FO9-10-12	1-14 ORFS M X 1 1/16 SAE M 90	EA	R169.44
1FO9-12	1 3/16 ORFS M X 1 1/16 SAE M 90	EA	R184.95
1FO9-12-08	1 3/16 ORFS M X 3/4-16 SAE M 90	EA	R234.73
1FO9-12-10	1 3/16 ORFS M X 7/8 SAE M 90	EA	R231.70
1FO9-12-16	1 3/16 ORFS M X 1 5/16 SAE M 90	EA	R257.25
1FO9-16	1 7/16 ORFS M X 1 5/16 SAE M 90	EA	R236.39
1FO9-16-12	1 7/16 ORFS M X 1 1/16 SAE M 90	EA	R409.93
1FO9-20	1 11/16 ORFS M X 1 5/8 SAE M 90	EA	R491.05
<b>JIC M - JIC M – Straight</b>			
1J-04	7/16 JIC M X 7/16 JIC M	EA	R11.70
1J-04-05	7/16 JIC M X 1/2-20 JIC M	EA	R14.95
1J-04-06	7/16 JIC M X 9/16 JIC M	EA	R16.98
1J-05	1/2-20 JIC M X 1/2-20 JIC M	EA	R13.22
1J-06	9/16 JIC M X 9/16 JIC M	EA	R17.89
1J-06-08	9/16 JIC M X 3/4-16 JIC M	EA	R20.54
1J-08	3/4-16 JIC M X 3/4-16 JIC M	EA	R22.74
1J-08-10	3/4-16 JIC M X 7/8 JIC M	EA	R30.89
1J-08-12	3/4-16 JIC M X 1 1/16 JIC M	EA	R40.66
1J-10	7/8 JIC M X 7/8 JIC M	EA	R32.31
1J-10-12	7/8 JIC M X 1 1/16 JIC M	EA	R52.20
1J-10-16	7/8 JIC M X 1 5/16 JIC M	EA	R89.99
1J-12	1 1/16 JIC M X 1 1/16 JIC M	EA	R46.02
1J-12-16	1 1/16 JIC M X 1 5/16 JIC M	EA	R54.67
1J-16	1 5/16 JIC M X 1 5/16 JIC M	EA	R66.37
1J-16-20	1 5/16 JIC M X 1 5/8 JIC M	EA	R101.10
1J-20	1 5/8 JIC M X 1 5/8 JIC M	EA	R90.38
1J-24	1 7/8 JIC M X 1 7/8 JIC M	EA	R143.94
1J-32	2 1/2 JIC M X 2 1/2 JIC M	EA	R270.46
<b>JIC M - JIC M - 90 Degree</b>			
1J9-04	7/16 JIC M X 7/16 JIC M 90	EA	R26.55
1J9-05	1/2-20 JIC M X 1/2-20 JIC M 90	EA	R42.40
1J9-06	9/16 JIC M X 9/16 JIC M 90	EA	R38.63
1J9-08	3/4-16 JIC M X 3/4-16 JIC M 90	EA	R43.60
1J9-10	7/8 JIC M X 7/8 JIC M 90	EA	R54.23
1J9-12	1 1/16 JIC M X 1 1/16 JIC M 90	EA	R79.29
1J9-16	1 5/16 JIC M X 1 5/16 JIC M 90	EA	R142.30
1J9-20	1 5/8 JIC M X 1 5/8 JIC M 90	EA	R202.16

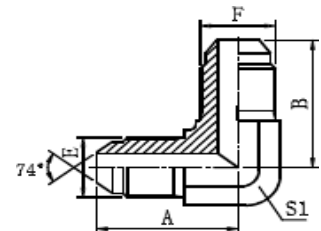
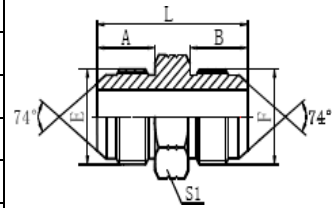

<b>JIC M - SAE FLANGE 3000psi – Straight</b>			
1JFL-12-12	1 1/16 JIC M X 1 1/16 SAE FL M	EA	R103.89
1JFL-12-16	1 1/16 JIC M X 1 5/16 SAE FL M	EA	R99.05
1JFL-16-16	1 5/16 JIC M X 1 5/16 SAE FL M	EA	R140.61
1JFL-20-20	1 5/8 JIC M X 1 5/8 SAE FL M	EA	R223.41
1JFL-24-24	1 7/8 JIC M X 1 7/8 SAE FL M	EA	R320.90
<b>JIC M - SAE FLANGE 3000psi - 90 Degree</b>			
1JFL9-12-12	1 1/16 JIC M X 1 1/16 SAE FL M 90	EA	R157.70
1JFL9-12-16	1 1/16 JIC M X 1 5/16 SAE FL M 90	EA	R235.15
1JFL9-16-16	1 5/16 JIC M X 1 5/16 SAE FL M 90	EA	R238.06
1JFL9-20-20	1 5/8 JIC M X 1 5/8 SAE FL M 90	EA	R337.22
1JFL9-24-24	1 7/8 JIC M X 1 7/8 SAE FL M 90	EA	R471.93
<b>JIC M - SAE FLANGE 6000psi – Straight</b>			
1JFS-12-12	1 1/16 JIC M X 1 1/16 SAE FL M	EA	R136.19
1JFS-16-16	1 5/16 JIC M X 1 5/16 SAE FL M	EA	R129.89
1JFS-20-20	1 5/8 JIC M X 1 5/8 SAE FL M	EA	R200.69
1JFS-24-24	1 7/8 JIC M X 1 7/8 SAE FL M	EA	R257.56

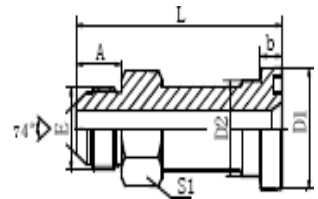
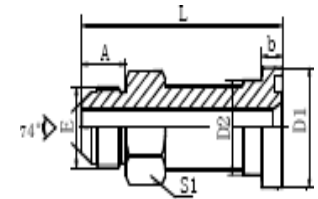
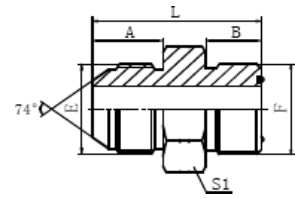

<b>JIC M - SAE FLANGE 6000psi - 90 Degree</b>			
1JFS9-12-12	1 1/16 JIC M X 1 1/16 SAE FL M 90	EA	R165.47
1JFS9-16-16	1 5/16 JIC M X 1 5/16 SAE FL M 90	EA	R225.51
1JFS9-20-20	1 5/8 JIC M X 1 5/8 SAE FL M 90	EA	R321.45
1JFS9-24-24	1 7/8 JIC M X 1 7/8 SAE FL M 90	EA	R495.32
<b>JIC M - BSP M - 45 Degree</b>			
1JG4-04	7/16 JIC M X 1/4 BSPP M 45	EA	R58.03
1JG4-06	9/16 JIC M X 3/8 BSPP M 45	EA	R71.17
1JG4-08	3/4-16 JIC M X 1/2 BSPP M 45	EA	R85.64
<b>JIC M - BSP M - 90 Degree</b>			
1JG9-04-02	7/16 JIC M X 1/8 BSPP M 90	EA	R33.91
1JG9-04-04	7/16 JIC M X 1/4 BSPP M 90	EA	R37.22
1JG9-04-06	7/16 JIC M X 3/8 BSPP M 90	EA	R55.62
1JG9-06-04	9/16 JIC M X 1/4 BSPP M 90	EA	R58.77
1JG9-06-06	9/16 JIC M X 3/8 BSPP M 90	EA	R55.22
1JG9-06-08	9/16 JIC M X 1/2 BSPP M 90	EA	R71.19
1JG9-08-04	3/4-16 JIC M X 1/4 BSPP M 90	EA	R104.33
1JG9-08-06	3/4-16 JIC M X 3/8 BSPP M 90	EA	R87.77
1JG9-08-08	3/4-16 JIC M X 1/2 BSPP M 90	EA	R61.48
1JG9-08-10	3/4-16 JIC M X 5/8 BSPP M 90	EA	R73.38
1JG9-08-12	3/4-16 JIC M X 3/4 BSPP M 90	EA	R83.76
1JG9-10-08	7/8 JIC M X 1/2 BSPP M 90	EA	R155.04
1JG9-10-12	7/8 JIC M X 3/4 BSPP M 90	EA	R85.59
1JG9-12-08	1 1/16 JIC M X 1/2 BSPP M 90	EA	R155.18
1JG9-12-12	1 1/16 JIC M X 3/4 BSPP M 90	EA	R97.01
1JG9-12-16	1 1/16 JIC M X 1 BSPP M 90	EA	R123.44
1JG9-16-12	1 5/16 JIC M X 3/4 BSPP M 90	EA	R260.80
1JG9-16-16	1 5/16 JIC M X 1 BSPP M 90	EA	R135.53
1JG9-16-20	1 5/16 JIC M X 1 1/4 BSPP M 90	EA	R218.61
1JG9-20-16	1 5/8 JIC M X 1 BSPP M 90	EA	R526.42
1JG9-20-20	1 5/8 JIC M X 1 1/4 BSPP M 90	EA	R239.36
1JG9-24-24	1 7/8 JIC M X 1 1/2 BSPP M 90	EA	R344.92
<b>JIC M - Metric M – Straight</b>			
1JH-04-12	7/16 JIC M X M12 M	EA	R22.26
1JH-04-22	7/16 JIC M X M22 M	EA	R42.24
1JH-06-14	9/16 JIC M X M14 M	EA	R22.92
1JH-06-16	9/16 JIC M X M16 M	EA	R27.53
1JH-06-18	9/16 JIC M X M18 M	EA	R32.12
1JH-08-14	3/4-16 JIC M X M14 M	EA	R22.92

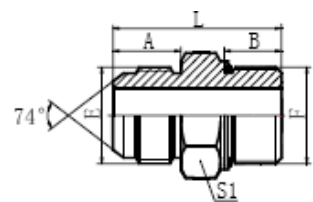
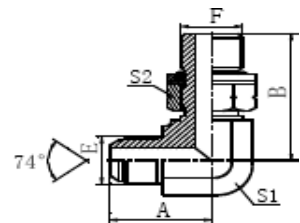
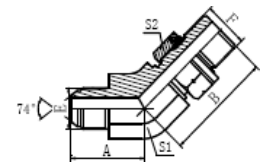
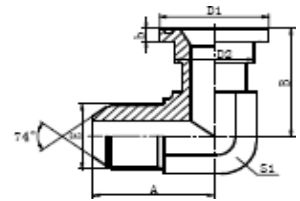



1JH-08-16	3/4-16 JIC M X M16 M	EA	R26.10
1JH-08-18	3/4-16 JIC M X M18 M	EA	R32.77
1JH-08-22	3/4-16 JIC M X M22 M	EA	R39.76
1JH-10-18	7/8 JIC M X M18 M	EA	R42.42
1JH-12-18	1 1/16 JIC M X M18 M	EA	R34.06
1JH-12-22	1 1/16 JIC M X M22 M	EA	R40.98
<b>JIC M - Metric M - 90 Degree</b>			
1JH9-06-16	9/16 JIC M X M16 M 90	EA	R52.82
1JH9-08-18	3/4-16 JIC M X M18 M 90	EA	R57.97
1JH9-08-22	3/4-16 JIC M X M22 M 90	EA	R73.91
<b>JIC M - NPT M – Straight</b>			
1JN-04-02	7/16 JIC M X 1/8 NPT M	EA	R15.35
1JN-04-04	7/16 JIC M X 1/4 NPT M	EA	R14.68
1JN-04-06	7/16 JIC M X 3/8 NPT M	EA	R18.36
1JN-04-08	7/16 JIC M X 1/2 NPT M	EA	R26.46
1JN-05-06	1/2-20 JIC M X 3/8 NPT M	EA	R22.12
1JN-06-02	9/16 JIC M X 1/8 NPT M	EA	R20.05
1JN-06-04	9/16 JIC M X 1/4 NPT M	EA	R21.82
1JN-06-06	9/16 JIC M X 3/8 NPT M	EA	R21.22
1JN-06-08	9/16 JIC M X 1/2 NPT M	EA	R25.50
1JN-06-12	9/16 JIC M X 3/4 NPT M	EA	R39.86
1JN-08-04	3/4-16 JIC M X 1/4 NPT M	EA	R24.02
1JN-08-06	3/4-16 JIC M X 3/8 NPT M	EA	R26.61
1JN-08-08	3/4-16 JIC M X 1/2 NPT M	EA	R29.51
1JN-08-12	3/4-16 JIC M X 3/4 NPT M	EA	R43.45
1JN-08-16	3/4-16 JIC M X 1 NPT M	EA	R73.43
1JN-10-06	7/8 JIC M X 3/8 NPT M	EA	R26.73
1JN-10-08	7/8 JIC M X 1/2 NPT M	EA	R35.32
1JN-10-12	7/8 JIC M X 3/4 NPT M	EA	R42.35
1JN-12-06	1 1/16 JIC M X 3/8 NPT M	EA	R49.05
1JN-12-08	1 1/16 JIC M X 1/2 NPT M	EA	R37.52
1JN-12-10	1 1/16 JIC M X 5/8 NPT M	EA	R61.88
1JN-12-12	1 1/16 JIC M X 3/4 NPT M	EA	R48.83
1JN-12-16	1 1/16 JIC M X 1 NPT M	EA	R61.77
1JN-12-20	1 1/16 JIC M X 1 1/14 NPT M	EA	R113.41
1JN-16-12	1 5/16 JIC M X 3/4 NPT M	EA	R80.41
1JN-16-16	1 5/16 JIC M X 1 NPT M	EA	R85.59
1JN-16-20	1 5/16 JIC M X 1 1/4 NPT M	EA	R122.06
1JN-20-16	1 5/8 JIC M X 1 NPT M	EA	R101.64

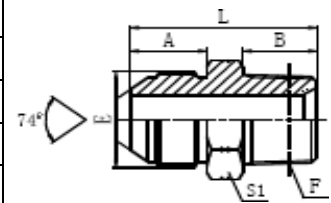
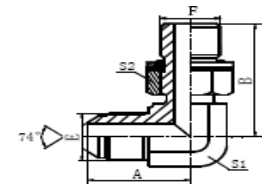

1JN-20-20	1 5/8 JIC M X 1 1/4 NPT M	EA	R127.45
1JN-20-24	1 5/8 JIC M X 1 1/2 NPT M	EA	R151.27
1JN-24-20	1 7/8 JIC M X 1 1/4 NPT M	EA	R175.82
1JN-24-24	1 7/8 JIC M X 1 1/2 NPT M	EA	R164.16
1JN-24-32	1 7/8 JIC M X 2 NPT M	EA	R436.18
1JN-32-32	2 1/2 JIC M X 2 NPT M	EA	R406.68
<b>JIC M - NPT M - 45 Degree</b>			
1JN4-04-04	7/16 JIC M X 1/4 NPT M 45	EA	R29.20
1JN4-04-06	7/16 JIC M X 3/8 NPT M 45	EA	R39.86
1JN4-04-08	7/16 JIC N X 1/2 NPT M 45	EA	R73.14
1JN4-06-04	9/16 JIC M X 1/4 NPT M 45	EA	R43.40
1JN4-06-06	9/16 JIC M X 3/8 NPT M 45	EA	R35.55
1JN4-06-08	9/16 JIC M X 1/2 NPT M 45	EA	R56.60
1JN4-08-08	3/4-16 JIC M X 1/2 NPT M 45	EA	R45.80
1JN4-08-12	3/4-16 JIC M X 3/4 MPT M 45	EA	R92.07
1JN4-12-12	1 1/16 JIC M X 3/4 NPT M 45	EA	R63.80
1JN4-12-16	1 1/16 JIC M X 1 NPT M 45	EA	R119.22
1JN4-16-16	1 5/16 JIC M X 1 NPT M 45	EA	R114.05
1JN4-16-20	1 5/16 JIC M X 1 1/4 NPT M 45	EA	R263.19
1JN4-20-20	1 5/8 JIC M X 1 1/4 NPT M 45	EA	R228.13
1JN4-24-24	1 7/8 JIC M X 1 1/2 NPT M 45	EA	R608.56
1JN4-32-32	2 1/2 JIC M X 2 NPT M 45	EA	R591.13
<b>JIC M - NPT M - 90 Degree</b>			
1JN9-04-02	7/16 JIC M X 1/8 NPT M 90	EA	R28.30
1JN9-04-04	7/16 JIC M X 1/4 NPT M 90	EA	R28.09
1JN9-04-06	7/16 JIC M X 3/8 NPT M 90	EA	R47.12
1JN9-06-04	9/16 JIC M X 1/4 NPT M 90	EA	R43.86
1JN9-06-06	9/16 JIC M X 3/8 NPT M 90	EA	R45.36
1JN9-06-08	9/16 JIC M X 1/2 NPT M 90	EA	R51.48
1JN9-08-06	3/4-16 JIC M X 3/8 NPT M 90	EA	R55.12
1JN9-08-08	3/4-16 JIC M X 1/2 NPT M 90	EA	R45.51
1JN9-08-12	3/4-16 JIC M X 3/4 NPT M 90	EA	R80.19
1JN9-10-08	7/8 JIC M X 1/2 NPT M 90	EA	R69.00
1JN9-10-12	7/8 JIC M X 3/4 NPT M 90	EA	R70.49
1JN9-12-08	1 1/16 JIC M X 1/2 NPT M 90	EA	R86.50
1JN9-12-12	1 1/16 JIC M X 3/4 NPT M 90	EA	R78.32
1JN9-12-16	1 1/16 JIC M X 1 NPT M 90	EA	R110.84
1JN9-12-20	1 1/16 JIC M X 1 1/4 NPTM 90	EA	R256.87
1JN9-16-12	1 5/16 JIC M X 3/4 NPT M 90	EA	R107.78

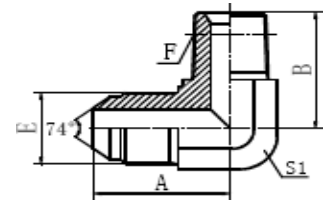
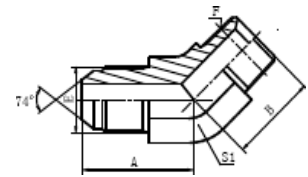

1JN9-16-16	1 5/16 JIC M X 1 NPT M 90	EA	R139.77
1JN9-16-20	1 5/16 JIC M X 1 1/4 NPT M 90	EA	R273.29
1JN9-20-16	1 5/8 JIC M X 1 NPT M 90	EA	R341.53
1JN9-20-20	1 5/8 JIC M X 1 1/4 NPT M 90	EA	R289.29
1JN9-20-24	1 5/8 JIC M X 1 1/2 NPT M 90	EA	R372.39
1JN9-24-20	1 7/8 JIC M X 1 1/4 NPT M 90	EA	R414.85
1JN9-24-24	1 7/8 JIC M X 1 1/2 NPT M 90	EA	R576.52
1JN9-32-32	2 1/2 JIC M X 2 NPT M 90	EA	R733.85
<b>JIC M - SAE M – Straight</b>			
1JO-04-04	7/16 JIC M X 7/16 SAE M	EA	R18.13
1JO-04-06	7/16 JIC M X 9/16 SAE M	EA	R18.37
1JO-04-08	7/16 JIC M X 3/4-16 SAE M	EA	R31.64
1JO-05-05	1/2-20 JIC M X 1/2-20 SAE M	EA	R16.39
1JO-05-06	1/2-20 JIC M X 9/16 SAE M	EA	R20.57
1JO-06-04	9/16 JIC M X 7/16 SAE M	EA	R24.11
1JO-06-06	9/16 JIC M X 9/16 SAE M	EA	R22.56
1JO-06-08	9/16 JIC M X 3/4-16 SAE M	EA	R29.53
1JO-06-10	9/16 JIC M X 7/8 SAE M	EA	R29.41
1JO-06-12	9/16 JIC M X 3/4-16 SAE M	EA	R45.93
1JO-08-06	3/4-16 JIC M X 9/16 SAE M	EA	R24.36
1JO-08-08	3/4-16 JIC M X 3/4-16 SAE M	EA	R29.16
1JO-08-10	3/4-16 JIC M X 7/8 SAE M	EA	R31.20
1JO-08-12	3/4-16 JIC M X 1 1/16 SAE M	EA	R47.38
1JO-10-08	7/8 JIC M X 3/4-16 SAE M	EA	R33.70
1JO-10-10	7/8 JIC M X 7/8 SAE M	EA	R36.40
1JO-10-12	7/8 JIC M X 1 1/16 SAE M	EA	R43.10
1JO-12-08	1 1/16 JIC M X 3/4-16 SAE M	EA	R50.11
1JO-12-10	1 1/16 JIC M X 7/8 SAE M	EA	R40.67
1JO-12-12	1 1/16 JIC M X 1 1/16 SAE M	EA	R48.16
1JO-12-16	1 1/16 JIC M X 1 5/16 SAE M	EA	R76.46
1JO-16-12	1 5/8 JIC M X 1 1/16 SAE M	EA	R75.29
1JO-16-16	1 5/16 JIC M X 1 5/16 SAE M	EA	R86.75
1JO-16-20	1 1/16 JIC M X 1 5/8 SAE M	EA	R162.95
1JO-20-16	1 5/8 JIC M X 1 5/16 SAE M	EA	R165.69
1JO-20-20	1 5/8 JIC M X 1 5/8 SAE M	EA	R130.84
1JO-20-24	1 5/8 JIC M X 1 7/8 SAE M	EA	R167.76
1JO-24-20	1 7/8 JIC M X 1 5/8 SAE M	EA	R275.55
1JO-24-24	1 7/8 JIC M X 1 7/8 SAE M	EA	R174.35
1JO-32-32	2 1/2 JIC M X 2 1/2 SAE M	EA	R211.95

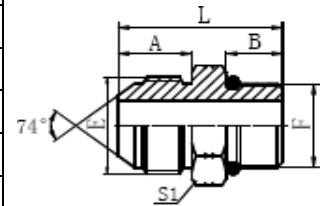

<b>JIC M - SAE M - 45 Degree</b>			
1JO4-04	7/16 JIC M X 7/16 SAE M 45	EA	R66.37
1JO4-06	9/16 JIC M X 9/16 SAE M 45	EA	R80.63
1JO4-08	3/4-16 JIC M X 3/4-16 SAE M 45	EA	R102.01
1JO4-10	7/8 JIC M X 7/8 SAE M 45	EA	R116.05
1JO4-12	1 1/16 JIC M X 1 1/16 SAE M 45	EA	R173.44
1JO4-16	1 5/16 JIC M X 1 5/16 SAE M 45	EA	R232.85
1JO4-20-20	1 5/8 JIC M X 1 5/8 SAE M	EA	R549.76
1JO4-24-24	1 7/8 JIC M X 1 7/8 SAE M	EA	R803.32
<b>JIC M - SAE M - 90 Degree</b>			
1JO9-04-04	7/16 JIC M X 7/16 SAE M 90	EA	R48.36
1JO9-04-06	7/16 JIC M X 9/16 SAE M 90	EA	R44.51
1JO9-06-04	9/16 JIC M X 7/16 SAE M 90	EA	R74.91
1JO9-06-06	9/16 JIC M X 9/16 SAE M 90	EA	R54.34
1JO9-06-08	9/16 JIC M X 3/4-16 SAE M 90	EA	R62.77
1JO9-08-06	3/4-16 JIC M X 9/16 SAE M 90	EA	R99.62
1JO9-08-08	3/4-16 JIC M X 3/4-16 SAE M 90	EA	R64.86
1JO9-08-10	3/4-16 JIC M X 7/8 SAE M 90	EA	R78.53
1JO9-08-12	3/4-16 JIC M X 1 1/16 SAE M 90	EA	R109.65
1JO9-10-08	7/8 JIC M X 3/4-16 SAE M 90	EA	R129.31
1JO9-10-10	7/8 JIC M X 7/8 SAE M 90	EA	R76.13
1JO9-10-12	7/8 JIC M X 1 1/16 SAE M 90	EA	R96.41
1JO9-12-08	1 1/16 JIC M X 3/4-16 SAE M 90	EA	R152.15
1JO9-12-12	1 1/16 JIC M X 1 1/16 SAE M 90	EA	R102.92
1JO9-12-16	1 1/16 JIC M X 1 5/16 SAE M 90	EA	R132.96
1JO9-16-16	1 5/16 JIC M X 1 5/16 SAE M 90	EA	R139.72
1JO9-20-16	1 5/8 JIC M X 1 5/16 SAE M 90	EA	R540.63
1JO9-20-20	1 5/8 JIC M X 1 5/8 SAE M 90	EA	R241.37
1JO9-20-24	1 5/8 JIC M X 1 7/8 SAE M 90	EA	R282.11
1JO9-24-24	1 7/8 JIC M X 1 7/8 SAE M 90	EA	R418.42
<b>NPT M - NPT M – Straight</b>			
1N-02	1/8 NPT M X 1/8 NPT M	EA	R12.06
1N-02-04	1/8 NPT M X 1/4 NPT M	EA	R15.78
1N-02-06	1/8 NPT M X 3/8 NPT M	EA	R19.54
1N-04	1/4 NPT M X 1/4 NPT M	EA	R18.79
1N-04-06	1/4 NPT M X 3/8 NPT M	EA	R19.41
1N-04-08	1/4 NPT M X 1/2 NPT M	EA	R30.20
1N-06	3/8 NPT M X 3/8 NPT M	EA	R23.72
1N-06-08	3/8 NPT M X 1/2 NPT M	EA	R21.82

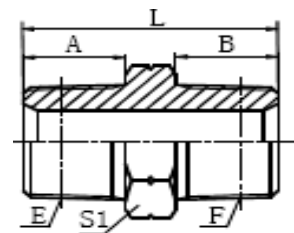
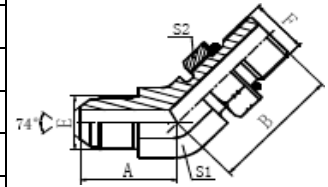

1N-08	1/2 NPT M X 1/2 NPT M	EA	R33.80
1N-08-12	1/2 NPT M X 3/4 NPT M	EA	R43.44
1N-08-16	1/2 NPT M X 1 NPT M	EA	R70.40
1N-12	3/4 NPT M X 3/4 NPT M	EA	R41.82
1N-12-16	3/4 NPT M X 1 NPT M	EA	R72.39
1N-12-20	3/4 NPT M X 1 1/4 NPT M	EA	R128.08
1N-16	1 NPT M X 1 NPT M	EA	R83.43
1N-16-20	1 NPT M X 1 1/4 NPT M	EA	R113.88
1N-16-24	1 NPT M X 1 1/2 NPT M	EA	R148.06
1N-20	1 1/4 NPT M X 1 1/4 NPT M	EA	R121.49
1N-20-24	1 1/4 NPT M X 1 1/2 NPT M	EA	R152.84
1N-24	1 1/2 NPT M X 1 1/2 NPT M	EA	R150.15
1N-24-32	1 1/2 NPT M X 2 NPT M	EA	R283.34
1N-32	2 NPT M X 2 NPT M	EA	R281.23
<b>NPT M - NPT M - 90 Degree</b>			
1N9-02	1/8 NPT M X 1/8 NPT M 90	EA	R28.56
1N9-02-04	1/8 NPT M X 1/4 NPT M 90	EA	R42.56
1N9-04	1/4 NPT M X 1/4 NPT M 90	EA	R31.31
1N9-06	3/8 NPT M X 3/8 NPT M 90	EA	R34.75
1N9-08	1/2 NPT M X 1/2 NPT M 90	EA	R48.28
1N9-12	3/4 NPT M X 3/4 NPT M 90	EA	R66.21
1N9-16	1 NPT M X 1 NPT M 90	EA	R137.90
1N9-20	1 1/4 NPT M X 1 1/4 NPT M 90	EA	R185.98
1N9-24	1 1/2 NPT M X 1 1/2 NPT M 90	EA	R265.85
1N9-32	2 NPT M X 2 NPT M 90	EA	R691.03
<b>BSP M - BSP Fem Swivel – Straight</b>			
2B-04	1/4 BSPP M X 1/4 BSPP F	EA	R28.52
2B-04-06	1/4 BSPP M X 3/8 BSPP F	EA	R31.94
2B-06	3/8 BSPP M X 3/8 BSPP F	EA	R30.50
2B-06-08	3/8 BSPP M X 1/2 BSPP F	EA	R34.69
2B-08	1/2 BSPP M X 1/2 BSPP F	EA	R52.81
2B-08-06	1/2 BSPP M X 3/8 BSPP F	EA	R50.20
2B-08-12	1/2 BSPP M X 3/4 BSPP F	EA	R67.62
2B-12	3/4 BSPP M X 3/4 BSPP F	EA	R75.42
2B-12-16	3/4 BSPP M X 1 BSPP F	EA	R90.90
2B-16	1 BSPP M X 1 BSPP F	EA	R123.66
<b>ORFS M - ORFS Fem Swivel – Straight</b>			
2F-04-06	9/16 ORFS M X 11/16 ORFS F	EA	R29.99
2F-06-04	11/16 ORFS M X 9/16 ORFS F	EA	R71.81

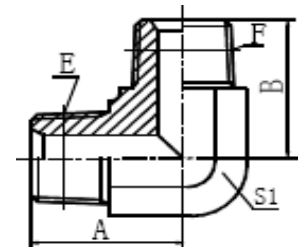

2F-06-08	11/16 ORFS M X 13/16 ORFS F	EA	R43.08
2F-08-06	13/16 ORFS M X 11/16 ORFS F	EA	R58.28
2F-08-10	13/16 ORFS M X 1-14 ORFS F	EA	R50.57
2F-08-12	13/16 ORFS M X 1 3/16 ORFS F	EA	R65.14
2F-10-12	1-14 ORFS M X 1 3/16 ORFS F	EA	R62.30
2F-12-08	1 3/16 ORFS M X 13/16 ORFS F	EA	R99.79
2F-12-16	1 3/16 ORFS M X 1 7/16 ORFS F	EA	R105.49
<b>ORFS M - ORFS Fem Swivel - 90 Degree</b>			
2F9-04	9/16 ORFS M X 9/16 ORFS F 90	EA	R55.70
2F9-06	11/16 ORFS M X 11/16 ORFS F 90	EA	R71.02
2F9-08	13/16 ORFS M X 13/16 ORFS F 90	EA	R83.90
2F9-10	1-14 ORFS M X 1-14 ORFS F 90	EA	R98.16
2F9-12	1 3/16 ORFS M X 1 3/16 ORFS F 90	EA	R152.75
2F9-16	1 7/16 ORFS M X 1 7/16 ORFS F 90	EA	R230.74
2F9-20	1 11/16 ORFS M X 1 11/16 ORFS F 90	EA	R303.92
2F9-24	2-12 ORFS M X 2-12 ORFS F 90	EA	R1235.56

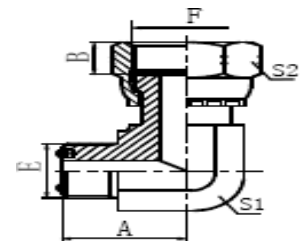
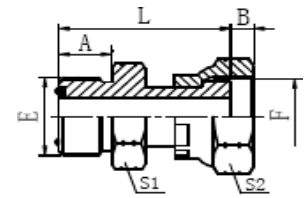

<b>JIC M - JIC Fem Swivel – Straight</b>			
2J-04	7/16 JIC M X 7/16 JIC F	EA	R23.62
2J-04-06	7.16 JIC M X 9/16 JIC F	EA	R19.66
2J-06	9/16 JIC M X 9/16 JIC F	EA	R25.45
2J-06-08	9/16 JIC M X 3/4-16 JIC F	EA	R36.75
2J-06-10	9/16 JIC M X 7/8 JIC F	EA	R48.21
2J-08	3/4-16 JIC M X 3/4-16 JIC F	EA	R44.51
2J-08-06	3/4-16 JIC M X 9/16 JIC F	EA	R35.28
2J-08-10	3/4-16 JIC M X 7/8 JIC F	EA	R49.95
2J-08-12	3/4-16 JIC M X 1 1/16 JIC F	EA	R51.15
2J-10-12	7/8 JIC M X 1 1/16 JIC F	EA	R45.02
2J-12	1 1/16 JIC M X 1 1/16 JIC F	EA	R67.53
2J-12-08	1 1/16 JIC M X 3/4-16 JIC F	EA	R91.48
2J-12-16	1 1/16 JIC M X 1 5/16 JIC F	EA	R68.53
2J-16	1 5/16 JIC M X 1 5/16 JIC F	EA	R116.32
<b>JIC M - JIC Fem Swivel - 45 Degree</b>			
2J4-04	7/16 JIC M X 7/16 JIC F 45	EA	R37.75
2J4-05	1/2-20 JIC M X 1/2-20 JIC F 45	EA	R72.60
2J4-06	9/16 JIC M X 9/16 F 45	EA	R58.66
2J4-08	3/4-16 JIC M X 3/4-16 JIC F 45	EA	R76.06
2J4-10	7/8 JIC M X 7/8 JIC F 45	EA	R67.74
2J4-12	1 1/16 JIC M X 1 1/16 JIC F 45	EA	R104.67
2J4-16	1 5/16 JIC M X 1 5/16 JIC F 45	EA	R154.99
2J4-20	1 5/8 JIC M X 1 5/8 JIC F 45	EA	R33.23
2J4-24	1 7/8 JIC M X 1 7/8 JIC F 45	EA	R580.15
2J4-32	2 1/2 JIC M X 2 1/2 JIC F 45	EA	R1086.72
<b>JIC M - JIC Fem Swivel - 90 Degree</b>			
2J9-04	1/4 JIC M X 1/4 JIC F 90	EA	R44.81
2J9-05	1/2-20 JIC M X 1/2-20 JIC F 90	EA	R58.70
2J9-06	9/16 JIC M X 9/16 JIC F 90	EA	R51.79
2J9-08	3/4-16 JIC M X 3/4-16 JIC F 90	EA	R71.66
2J9-10	7/8 JIC M X 7/8 JIC F 90	EA	R75.72
2J9-12	1 1/16 JIC M X 1 1/16 JIC F 90	EA	R106.71
2J9-16	1 5/16 JIC M X 1 5/16 JIC F 90	EA	R176.26
2J9-20	1 5/8 JIC M X 1 5/8 JIC F 90	EA	R434.74
2J9-24	1 7/8 JIC M X 1 7/8 JIC F 90	EA	R572.76
2J9-32	2 1/2 JIC M X 2 1/2 JIC F 90	EA	R923.24
<b>NPT M - JIC Fem Swivel – Straight</b>			
2NJ-04-04	1/4 NPT M X 7/16 JIC F	EA	R33.00

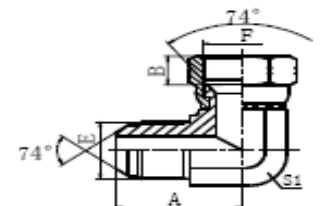
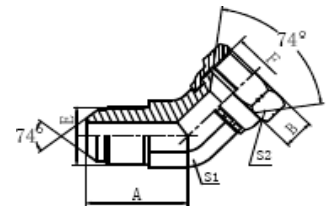
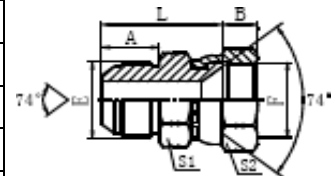

2NJ-04-06	1/4 NPT M X 9/16 JIC F	EA	R39.72
2NJ-06-06	3/8 NPT M X 9/16 JIC F	EA	R49.28
2NJ-06-08	3/8 NPT M X 3/4-16 JIC F	EA	R61.48
2NJ-08-06	1/2 NPT M X 9/16 JIC F	EA	R75.24
2NJ-08-08	1/2 NPT M X 3/4-16 JIC F	EA	R49.10
2NJ-08-10	1/2 NPT M X 7/8 JIC F	EA	R63.37
2NJ-08-12	1/2 NPT M X 1 1/16 JIC F	EA	R81.43
2NJ-12-12	3/4 NPT M X 1 1/16 JIC F	EA	R71.95
2NJ-16-16	1 NPT M X 1 5/16 JIC F	EA	R147.61
2NJ-20-20	1 1/4 NPT M X 1 5/8 JIC F	EA	R275.47
2NJ-24-24	1 1/2 NPT M X 1 7/8 JIC F	EA	R338.76
<b>NPT M - NPT Fem Swivel – Straight</b>			
2NU-02	1/8 NPT M X 1/8 NPT F	EA	R24.76
2NU-02-04	1/8 NPT M X 1/4 NPT F	EA	R35.38
2NU-04	1/4 NPT M X 1/4 NPT F	EA	R25.51
2NU-04-06	1/4 NPT M X 3/8 NPT F	EA	R35.64
2NU-06	3/8 NPT M X 3/8 NPT F	EA	R29.96
2NU-06-04	3/8 NPT M X 1/4 NPT F	EA	R35.66
2NU-06-08	3/8 NPT M X 1/2 NPT F	EA	R46.68
2NU-08	1/2 NPT M X 1/2 NPT F	EA	R42.57
2NU-08-06	1/2 NPT M X 3/8 NPT F	EA	R42.19
2NU-08-12	1/2 NPT M X 3/4 NPT F	EA	R81.88
2NU-12	3/4 NPT M X 3/4 NPT F	EA	R70.29
2NU-12-08	3/4 NPT M X 1/2 NPT F	EA	R75.29
2NU-12-16	3/4 NPT M X 1 NPT F	EA	R129.38
2NU-16	1 NPT M X 1 NPT F	EA	R139.62
2NU-16-12	1 NPT M X 3/4 NPT F	EA	R153.61
2NU-20-20	1 1/4 NPT M X 1 1/4 NPT F	EA	R174.07
2NU-24-24	1 1/2 NPT M X 1 1/2 NPT F	EA	R259.19
2NU-32-32	2 NPT M X 2 NPT F	EA	R444.37

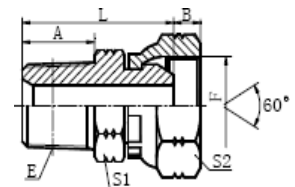
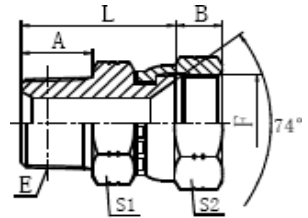



<b>NPT M - NPT Fem Swivel - 90 Degree</b>			
2NU9-02	1/8 NPT M X 1/8 NPT F 90	EA	R45.63
2NU9-04	1/4 NPT M X 1/4 NPT F 90	EA	R47.42
2NU9-04-06	1/4 NPT M X 3/8 NPT F 90	EA	R63.47
2NU9-06	3/8 NPT M X 3/8 NPT F 90	EA	R48.45
2NU9-06-04	3/8 NPT M X 1/4 NPT F 90	EA	R55.44
2NU9-06-08	3/8 NPT M X 1/2 NPT F 90	EA	R78.26
2NU9-08	1/2 NPT M X 1/2 NPT F 90	EA	R70.17
2NU9-12	3/4 NPT M X 3/4 NPT F 90	EA	R109.56
2NU9-16	1 NPT M X 1 NPT F 90	EA	R202.14
2NU9-20	1 1/4 NPT M X 1 1/4 NPT F 90	EA	R450.13
2NU9-24	1 1/2 NPT M X 1 1/2 NPT F 90	EA	R600.27
2NU9-32-32	2 NPT M X 2 NPT F 90	EA	R1138.99
<b>BSP M Hex Plug</b>			
4B-02	1/8 BSPP M PLUG	EA	R11.07
4B-04	1/4 BSPP M PLUG	EA	R15.78
4B-06	3/8 BSPP M PLUG	EA	R18.22
4B-08	1/2 BSPP M PLUG	EA	R24.86
4B-10	5/8 BSPP M PLUG	EA	R29.50
4B-12	3/4 BSPP M PLUG	EA	R33.48
4B-16	1 BSPP M PLUG	EA	R59.51
4B-20	1 1/4 BSPP M PLUG	EA	R98.08
4B-24	1 1/2 BSPP M PLUG	EA	R149.12
4B-32	2 BSPP M PLUG	EA	R251.03
<b>ORFS M Hex Plug</b>			
4F-04	9/16 ORFS M PLUG	EA	R19.43
4F-06	1 1/16 ORFS M PLUG	EA	R21.59
4F-08	1 3/16 ORFS M PLUG	EA	R24.43
4F-10	1-14 ORFS M PLUG	EA	R27.76
4F-12	1 3/16 ORFS M PLUG	EA	R34.31
4F-16	1 7/16 ORFS M PLUG	EA	R54.93
4F-20	1 11/16 ORFS M PLUG	EA	R94.93
4F-24	2-12 ORFS M PLUG	EA	R148.60
<b>JIC M Hex Plug</b>			
4J-04	7/16 JIC M PLUG	EA	R12.74
4J-05	1/2-20 JIC M PLUG	EA	R14.98
4J-06	9/16 JIC M PLUG	EA	R17.02
4J-08	3/4-16 JIC M PLUG	EA	R19.41
4J-10	7/8 JIC M PLUG	EA	R24.89

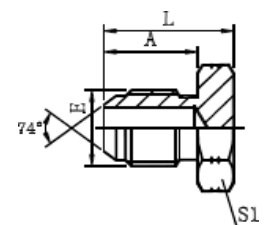
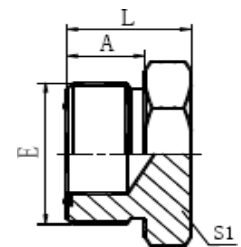
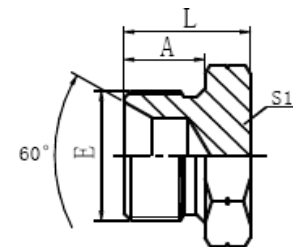
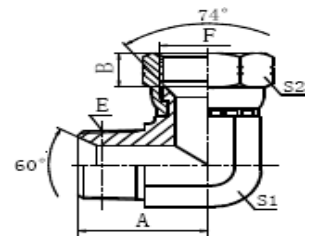

4J-12	1 1/16 JIC M PLUG	EA	R35.99
4J-14	1 3/16 JIC M PLUG	EA	R45.19
4J-16	1 5/16 JIC M PLUG	EA	R49.15
4J-20	1 5/8 JIC M PLUG	EA	R87.38
4J-24	1 7/8 JIC M PLUG	EA	R128.04
4J-32	2 1/2 JIC M PLUG	EA	R271.36
<b>NPT M Hex Plug</b>			
4N-02	1/8 NPT PLUG	EA	R12.11
4N-04	1/4 NPT PLUG	EA	R13.74
4N-06	3/8 NPT PLUG	EA	R15.78
4N-08	1/2 NPT PLUG	EA	R23.82
4N-12	3/4 NPT PLUG	EA	R29.76
4N-16	1 NPT PLUG	EA	R44.88
4N-20	1 1/4 NPT PLUG	EA	R87.11
4N-24	1 1/2 NPT PLUG	EA	R102.98
4N-32	2 NPT PLUG	EA	R226.39
<b>SAE M Hex Plug</b>			
4O-04	7/16 SAE PLUG	EA	R14.38
4O-05	1/2-20 SAE PLUG	EA	R11.11
4O-06	9/16 SAE PLUG	EA	R15.59
4O-08	3/4-16 SAE PLUG	EA	R17.05
4O-10	7/8 SAE PLUG	EA	R26.83
4O-12	1 1/16 SAE PLUG	EA	R34.31
4O-14	1 3/16 SAE PLUG	EA	R52.15
4O-16	1 5/16 SAE PLUG	EA	R49.70
4O-20	1 5/8 SAE PLUG	EA	R101.41
4O-24	1 7/8 SAE PLUG	EA	R145.59
4O-32	2 1/2 SAE PLUG	EA	R246.85
<b>JIC M - JIC Fem Fixed – Straight</b>			
5J-04-06	7/16 JIC M X 9/16 JIC F	EA	R20.57
5J-04-08	7/16 JIC M X 3/4 - 16 JIC F	EA	R29.34
5J-06-08	9/16 JIC M X 3/4 -16 JIC F	EA	R28.10
5J-06-10	9/16 JIC M X 7/8 JIC F	EA	R53.73
5J-06-12	9/16 JIC M X 1 1/16 JIC F	EA	R53.97
5J-08-12	3/4 -16 JIC M X 1 1/16 JIC F	EA	R69.53
5J-08-16	3/4 -16 JIC M X 1 5/16 JIC F	EA	R48.56
5J-12-16	1 1/16 JIC M X 1 5/16 JIC F	EA	R68.04
5J-16-20	1 5/16 JIC M X 1 5/8 JIC F	EA	R127.87
5J-20-24	1 5/8 JIC M X 1 7/8 JIC F	EA	R182.33

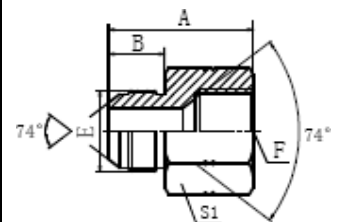
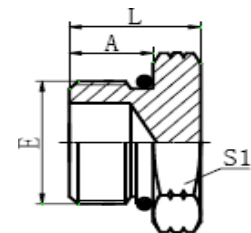
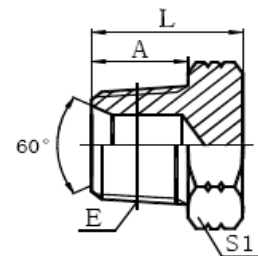

<b>NPT M - NPT Fem Fixed – Straight</b>			
5N-02-02	1/8 NPT M X 1/8 NPT F	EA	R17.04
5N-02-04	1/8 NPT M X 1/4 NPT F	EA	R17.04
5N-04-02	1/4 NPT M X 1/8 NPT F	EA	R15.17
5N-04-04	1/4 NPT M X 1/4 NPT F	EA	R19.78
5N-04-06	1/4 NPT M X 3/8 NPT F	EA	R30.09
5N-06-02	3/8 NPT M X 1/8 NPT F	EA	R34.01
5N-06-04	3/8 NPT M X 1/4 NPT F	EA	R28.79
5N-06-06	3/8 NPT M X 3/8 NPT F	EA	R30.01
5N-06-08	3/8 NPT M X 1/2 NPT F	EA	R44.28
5N-08-02	1/2 NPT M X 1/8 NPT F	EA	R36.01
5N-08-04	1/2 NPT M X 1/4 NPT F	EA	R38.18
5N-08-06	1/2 NPT M X 3/8 NPT F	EA	R39.07
5N-08-08	1/2 NPT M X 1/2 NPT F	EA	R43.49
5N-08-12	1/2 NPT M X 3/4 NPT F	EA	R51.04
5N-12-04	3/4 NPT M X 1/4 NPT F	EA	R51.06
5N-12-06	3/4 NPT M X 3/8 NPT F	EA	R51.06
5N-12-08	3/4 NPT M X 1/2 NPT F	EA	R51.06
5N-12-12	3/4 NPT M X 3/4 NPT F	EA	R47.87
5N-12-16	3/4 NPT M X 1 NPT F	EA	R68.07
5N-16-08	1 NPT M X 1/2 NPT F	EA	R58.92
5N-16-12	1 NPT M X 3/4 NPT F	EA	R56.93
5N-20-12	1 1/4 NPT M X 3/4 NPT F	EA	R73.69
5N-20-16	1 1/4 NPT M X 1 NPT F	EA	R75.02
5N-24-12	1 1/2 NPT M X 3/4 NPT F	EA	R103.15
5N-24-16	1 1/2 NPT M X 1 NPT F	EA	R103.15
5N-24-20	1 1/2 NPT M X 1 1/4 NPT F	EA	R98.43
5N-32-16	2 NPT M X 1 NPT F	EA	R246.74
5N-32-20	2 NPT M X 1 1/4 NPT F	EA	R215.89
5N-32-24	2 NPT M X 1 1/2 NPT F	EA	R246.74
<b>NPT M - NPT Fem Fixed - 90 Degree</b>			
5N9-02	1/8 NPT M X 1/8 NPT F 90	EA	R45.81
5N9-04	1/4 NPT M X 1/4 NPT F 90	EA	R51.43
5N9-06	3/8 NPT M X 3/8 NPT F 90	EA	R55.56
5N9-08	1/2 NPT M X 1/2 NPT F 90	EA	R73.27
5N9-12	3/4 NPT M X 3/4 NPT F 90	EA	R121.51
5N9-16	1 NPT M X 1 NPT F 90	EA	R215.49
5N9-20	1 1/4 NPT M X 1 1/4 NPT F 90	EA	R397.00
5N9-24	1 1/2 NPT M X 1 1/2 NPT F 90	EA	R866.60

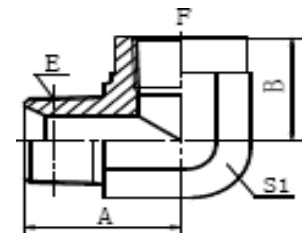
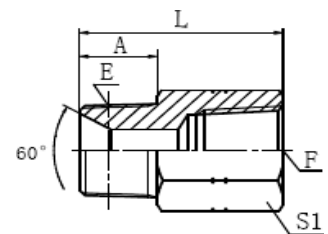

5N9-32	2 NPT M X 2 NPT F 90	EA	R902.46
<b>BSP Bulkhead with Locknut – Straight</b>			
6B-04LNZ	1/4 BSPP B/H STR	EA	R37.38
6B-06LNZ	3/8 BSPP B/H STR	EA	R39.49
6B-08LNZ	1/2 BSPP B/H STR	EA	R57.68
6B-10LNZ	5/8 BSPP B/H STR	EA	R64.15
6B-12LNZ	3/4 BSPP B/H STR	EA	R81.31
6B-16LNZ	1 BSPP B/H STR	EA	R157.93
6B-20LNZ	1 1/4 BSPP B/H	EA	R223.39
6B-24LNZ	1 1/2 BSPP B/H STR	EA	R283.57
<b>ORFS Bulkhead with Locknut – Straight</b>			
6F-04LNZ	9/16 ORFS B/H STR	EA	R22.51
6F-06LNZ	1 1/16 ORFS B/H STR	EA	R26.84
6F-08LNZ	13/16 ORFS B/H STR	EA	R41.82
6F-10LNZ	1-14 ORFS B/H STR	EA	R55.32
6F-12LNZ	1 3/16 ORFS B/H STR	EA	R76.13
6F-16LNZ	1 7/16 ORFS B/H STR	EA	R111.06
<b>JIC Bulkhead with Locknut – Straight</b>			
6J-04LNZ	7/16 JIC B/H STR	EA	R35.25
6J-05LNZ	1/2-20 JIC B/H STR	EA	R41.82
6J-06LNZ	9/16 JIC B/H STR	EA	R36.19
6J-08LNZ	3/4-16 JIC B/H STR	EA	R46.68
6J-10LNZ	7/8 JIC B/H STR	EA	R77.66
6J-12LNZ	1 1/16 JIC B/H STR	EA	R114.07
6J-16LNZ	1 5/16 JIC B/H STR	EA	R159.55
6J-20LNZ	1 5/8 JIC B/H STR	EA	R240.19
6J-24LNZ	1 7/8 JIC B/H STR	EA	R346.30
6J-32LNZ	2 1/2 JIC B/H STR	EA	R590.55
<b>JIC Bulkhead with Locknut - 90 Degree</b>			
6J9-04LNZ	7/16 JIC B/H 90	EA	R61.83
6J9-06LNZ	9/16 JIC B/H 90	EA	R67.88
6J9-08LNZ	3/4-16 JIC B/H 90	EA	R95.60
6J9-10LNZ	7/8 JIC B/H 90	EA	R136.47
6J9-12LNZ	1 1/16 JIC B/H 90	EA	R157.98
6J9-16LNZ	1 5/16 JIC B/H 90	EA	R248.88
<b>Metric Banjo Bolt – Single</b>			
700M-12	12 X 1.5 M BANJO BOLT	EA	R18.91
700M-14	14 X 1.5 M BANJO BOLT	EA	R19.63
700M-16	16 X 1.5 M BANJO BOLT	EA	R26.21

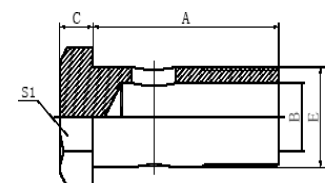
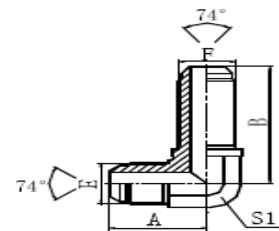
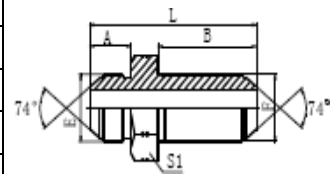
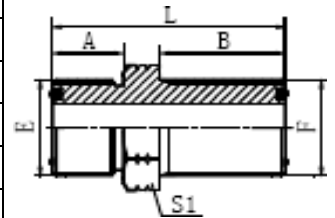
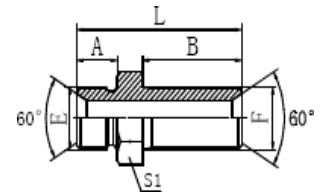

700M-18	18 X 1.5 M BANJO BOLT	EA	R33.01
700M-22	22 X 1.5 M BANJO BOLT	EA	R42.20
<b>BSP Banjo Bolt – Single</b>			
720B-04	1/4 BSPP BANJO BOLT	EA	R19.37
720B-06	3/8 BSPP BANJO BOLT	EA	R27.52
720B-08	1/2 BSPP BANJO BOLT	EA	R38.72
720B-10	5/8 BSPP BANJO BOLT	EA	R48.90
720B-12	3/4 BSPP BANJO BOLT	EA	R66.39
<b>BSP Socket – Straight</b>			
7B-02	1/8 BSPP F SOCKET	EA	R14.10
7B-04	1/4 BSPP F SOCKET	EA	R22.76
7B-06	3/8 BSPP F SOCKET	EA	R28.85
7B-08	1/2 BSPP F SOCKET	EA	R45.03
7B-12	3/4 BSPP F SOCKET	EA	R59.44
7B-16	1 BSPP F SOCKET	EA	R87.82
7B-20	1 1/4 BSPP F SOCKET	EA	R112.35
7B-24	1 1/2 BSPP F SOCKET	EA	R386.60
<b>NPT Socket – Straight</b>			
7N-02	1/8 NPT F SOCKET	EA	R23.98
7N-02-04	1/8 X 1/4 NPT SOCKET	EA	R13.71
7N-04-04	1/4 X 1/4 NPT SOCKET	EA	R22.09
7N-04-06	1/4 X 3/8 NPT SOCKET	EA	R23.50
7N-04-08	1/4 X 1/2 NPT SOCKET	EA	R37.66
7N-06-06	3/8 X 3/8 NPT SOCKET	EA	R26.60
7N-06-08	3/8 X 1/2 NPT SOCKET	EA	R37.40
7N-08-08	1/2 X 1/2 NPT SOCKET	EA	R39.34
7N-08-12	1/2 X 3/4 NPT SOCKET	EA	R62.74
7N-12-12	3/4 X 3/4 NPT SOCKET	EA	R52.18
7N-12-16	3/4 X 1 NPT SOCKET	EA	R102.55
7N-16-16	1 X 1 NPT SOCKET	EA	R88.49
7N-20-20	1 1/4 X 1 1/4 NPT SOCKET	EA	R132.69
7N-24-24	1 1/2 X 1 1/2 NPT SOCKET	EA	R171.00
7N-32-32	2 X 2 NPT SOCKET	EA	R452.75
<b>NPT Socket - 90 Degree</b>			
7N9-02	1/8 X 1/8 NPT F 90	EA	R43.40
7N9-04	1/4 X 1/4 NPT F 90	EA	R44.30
7N9-06	3/8 X 3/8 NPT F 90	EA	R58.56
7N9-08	1/2 X 1/2 NPT F 90	EA	R86.17
7N9-12	3/4 X 3/4 NPT F 90	EA	R136.93

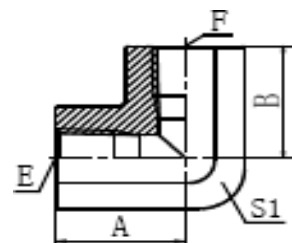
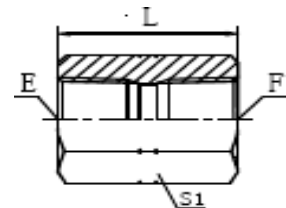
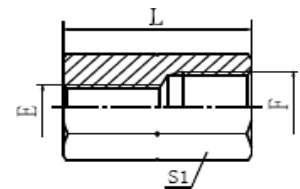
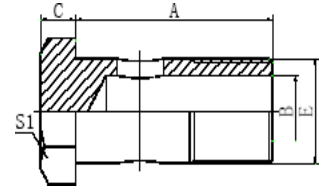

7N9-16	1 X 1 NPT F 90	EA	R195.99
7N9-20	1 1/4 X 1 1/4 NPT F 90	EA	R388.78
7N9-24	1 1/2 X 1 1/2 NPT F 90	EA	R737.67
7N9-32	2 X 2 NPT F 90	EA	R782.43
<b>BSP Female Cap</b>			
9B-02	1/8 BSPP F CAP	EA	R14.45
9B-04	1/4 BSPP F CAP	EA	R23.07
9B-06	3/8 BSPP F CAP	EA	R27.61
9B-08	1/2 BSPP F CAP	EA	R40.53
9B-10	5/8 BSPP F CAP	EA	R44.86
9B-12	3/4 BSPP F CAP	EA	R50.43
9B-16	1 BSPP F CAP	EA	R81.07
9B-20	1 1/4 BSPP F CAP	EA	R104.12
<b>ORFS Female Cap</b>			
9F-04	9/16 ORFS F CAP	EA	R15.78
9F-06	11/16 ORFS F CAP	EA	R18.13
9F-08	13/16 ORFS F CAP	EA	R24.69
9F-10	1-14 ORFS F CAP	EA	R32.36
9F-12	1 3/16 ORFS F CAP	EA	R46.76
9F-16	1 7/16 ORFS F CAP	EA	R87.33
9F-20	1 11/16 ORFS F CAP	EA	R124.29
9F-24	2-1/2 ORFS F CAP	EA	R281.17
<b>JIC Female Cap</b>			
9J-04	7/16 JIC F CAP	EA	R24.09
9J-05	1.2-20 JIC F CAP	EA	R24.13
9J-06	9/16 JIC F CAP	EA	R32.37
9J-08	3/4 -16 JIC F CAP	EA	R36.80
9J-10	7/8 JIC F CAP	EA	R46.09
9J-12	1 1/16 JIC F CAP	EA	R57.18
9J-14	1 3/16 JIC F CAP	EA	R80.31
9J-16	1 5/16 JIC F CAP	EA	R89.28
9J-20	1 5/8 JIC F CAP	EA	R119.08
9J-24	1 7/8 JIC F CAP	EA	R157.04
9J-32	2 1/2 JIC F CAP	EA	R353.44
<b>Metric Female Cap</b>			
9M-12	12 X 1.5 METRIC F CAP	EA	R17.80
9M-14	14 X 1.5 METRIC F CAP	EA	R20.91
9M-16	16 X 1.5 METRIC F CAP	EA	R34.72
9M-18	18 X 1.5 METRIC F CAP	EA	R33.38

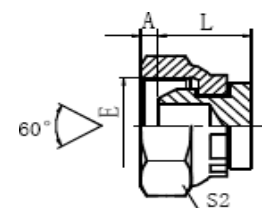
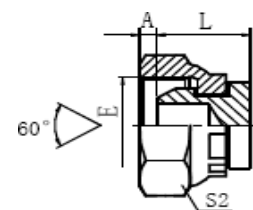
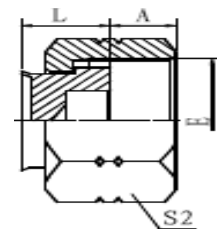
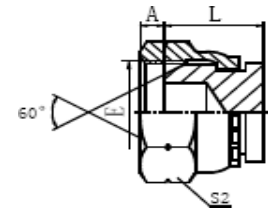

JIC Male Tee-Piece			
AJ-04	7/16 JIC M TEE	EA	R48.79
AJ-06	9/16 JIC M TEE	EA	R61.16
AJ-08	3/4-16 JIC M TEE	EA	R78.36
AJ-10	7/8 JIC M TEE	EA	R102.98
AJ-12	1 1/16 JIC M TEE	EA	R144.04
AJ-16	1 5/16 JIC M TEE	EA	R255.18
AJ-20	1 5/8 JIC M TEE	EA	R567.33
AJ-24	1 7/8 JIC M TEE	EA	R677.78
JIC Fem Branch Tee-Piece			
BJ-04	7/16 JIC M/F/M BRANCH TEE	EA	R63.36
BJ-06	9/16 JIC M/F/M BRANCH TEE	EA	R68.83
BJ-08	3/4-16 JIC M/F/M BRANCH TEE	EA	R85.28
BJ-10	7/8 JIC M/F/M BRANCH TEE	EA	R126.21
BJ-12	3/4-16 JIC M/F/M BRANCH TEE	EA	R138.55
BJ-16	1 5/16 JIC M/F/M BRANCH TEE	EA	R225.25
BJ-20	1 5/8 JIC M/F/M BRANCH TEE	EA	R787.55

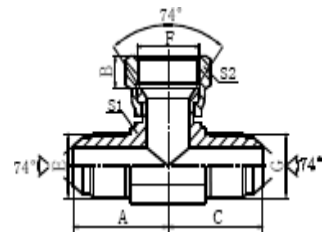
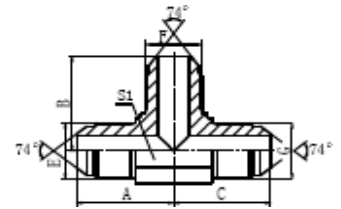

<b>JIC Fem Run Tee-Piece</b>			
CJ-04	9/16 JIC M/M/F RUN TEE	EA	R72.92
CJ-06	9/16 JIC M/M/F RUN TEE	EA	R75.50
CJ-08	3/4-16 M/M/F RUN TEE	EA	R109.45
CJ-10	7/8 JIC M/M/F RUN TEE	EA	R110.78
CJ-12	1 1/16 JIC M/M/F TEE	EA	R162.50
CJ-16	1 5/16 JIC M/M/F RUN TEE	EA	R317.26
CJ-20	1 5/8 JIC M/M/F RUN TEE	EA	R567.02
CJ-24	1 7/8 JIC M/M/F RUN TEE	EA	R809.99
<b>BSP Dowty Washer</b>			
125480	1/8 DOWTY WASHER	EA	R4.15
125481	1/4 DOWTY WASHER	EA	R4.65
125482	3/8 DOWTY WASHER	EA	R5.02
DW-08	1/2 DOWTY WASHER	EA	R6.00
125488	5/8 DOWTY WASHER	EA	R9.96
125484	3/4 DOWTY WASHER	EA	R8.81
125485	1 DOWTY WASHER	EA	R12.71
125486	1 1/4 DOWTY WASHER	EA	R19.36
125487	1 1/2 DOWTY WASHER	EA	R25.31
125489	2 DOWTY WASHER	EA	R39.40
<b>Metric Dowty Washer</b>			
125491	6mm DOWTY WASHER	EA	R3.21
125492	8mm DOWTY WASHER	EA	R6.18
125493	10mm DOWTY WASHER	EA	R6.18
125494	12mm DOWTY WASHER	EA <td R6.56	
125495	14mm DOWTY WASHER	EA	R10.03
125496	16mm DOWTY WASHER	EA	R7.46
125498	18mm DOWTY WASHER	EA	R8.36
125499	20mm DOWTY WASHER	EA	R12.29
125500	22mm DOWTY WASHER	EA	R9.57
125501	24mm DOWTY WASHER	EA	R15.73
125484	26mm DOWTY WASHER	EA	R22.62
125504	30mm DOWTY WASHER	EA	R25.15
DWM-36	36mm DOWTY WASHER	EA	R47.06
DWM-42	42mm DOWTY WASHER	EA	R97.30

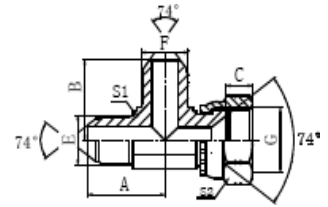



3000psi Split Flange – Set			
FL-08	1/2 SPLIT FLANGE 3000 SET	EA	R63.03
FL-12	3/4 SPLIT FLANGE 3000 SET	EA	R72.00
FL-16	1 SPLIT FLANGE 3000 SET	EA	R80.08
FL-20	1 1/4 SPLIT FLANGE 3000 SET	EA	R126.57
FL-24	1 1/2 SPLIT FLANGE 3000 SET	EA	R169.72
FL-32	2 SPLIT FLANGE 3000 SET	EA	R182.26
6000psi Split Flange – Set			
FS-08	1/2 SPLIT FLANGE 6000 SET	EA	R63.00
FS-12	3/4 SPLIT FLANGE 6000 SET	EA	R90.02
FS-16	1 SPLIT FLANGE 6000 SET	EA	R130.48
FS-20	1 1/4 SPLIT FLANGE 6000 SET	EA	R258.88
FS-24	1 1/2 SPLIT FLANGE 6000 SET	EA	R326.27
FS-32	2 SPLIT FLANGE 6000 SET	EA	R615.52
BSPP Female Tee-Piece			
GB-04	1/4 BSPP F TEE	EA	R81.90
GB-06	3/8 BSPP F TEE	EA	R107.34
GB-08	1/2 BSPP F TEE	EA	R129.61
GB-12	3/4 BSPP F TEE	EA	R198.93
GB-16	1 BSPP F TEE	EA	R295.64
GB-20	1 1/4 BSPP F TEE	EA	
GB-24	1 1/2 BSPP F TEE	EA	
NPT Female Tee-Piece			
GN-02	1/8 NPT F TEE	EA	R60.63
GN-04	1/4 NPT F TEE	EA	R66.52
GN-06	3/8 NPT F TEE	EA	R81.40
GN-08	1/2 NPT F TEE	EA	R136.81
GN-12	3/4 NPT F TEE	EA	R197.77
GN-16	1 NPT F TEE	EA	R377.52
GN-20	1 1/4 NPT F TEE	EA	R530.69
GN-24	1 1/2 NPT F TEE	EA	R633.92
GN-32	2 NPT F TEE	EA	R939.14

