

Hose Fittings			
PART NUMBER	DESCRIPTION	UNIT	LIST PRICE
Metric Male Hose Fittings			
10411-12-04	(6L) M12 METRIC M X 1.5 X 1/4 TAIL	EA	R20.28
10411-14-04	(8L) M14 METRIC M X 1.5 X 1/4 TAIL	EA	R20.28
10411-16-04	(10L) M16 METRIC M X 1.5 X 1/4 TAIL	EA	R22.18
10411-16-06	(10L) M16 METRIC M X 1.5 X 3/8 TAIL	EA	R23.71
10411-18-04	(12L) M18 METRIC M X 1.5 X 1/4 TAIL	EA	R23.71
10411-18-06	(12L) M18 METRIC M X 1.5 X 3/8 TAIL	EA	R25.19
10411-22-06	(15L) M22 METRIC M X 1.5 X 3/8 TAIL	EA	R35.10
10411-22-08	(15L) M22 METRIC M X 1.5 X 1/2 TAIL	EA	R36.16
10411-26-08	(18L) M26 METRIC M X 1.5 X 1/2 TAIL	EA	R38.47
10411-26-10	(18L) M26 METRIC M X 1.5 X 5/8 TAIL	EA	R45.20
10411-30-12	(22L) M30 METRIC M X 2 X 3/4 TAIL	EA	R54.96
10411-36-16	(28L) M36 METRIC M X 2 X 1 TAIL	EA	R120.52
10411-45-20	(35L) M45 METRIC M X 2 X 1 1/4 TAIL	EA	R158.47
10411-52-24	(42L) M52 METRIC M X 2 X 1 1/2 TAIL	EA	R168.96
10511-16-04	(8S) M16 METRIC M X 1.5 X 1/4 TAIL	EA	R21.12
10511-18-04	(10S) M18 METRIC M X 1.5 X 1/4 TAIL	EA	R24.87
10511-20-06	(12S) M20 METRIC M X 1.5 X 3/8 TAIL	EA	R34.04
10511-22-06	(14S) M22 METRIC M X 1.5 X 3/8 TAIL	EA	R36.79
10511-24-08	(16S) M24 METRIC M X 1.5 X 1/2 TAIL	EA	R42.54
10511-30-10	(20S) M30 METRIC M X 2 X 5/8 TAIL	EA	R59.72
10511-30-12	(20S) M30 METRIC M X 2 X 3/4 TAIL	EA	R61.51
10511-36-12	(25S) M36 METRIC M X 2 X 3/4 TAIL	EA	R108.45
10511-42-16	(30S) M42 METRIC M X 2 X 1 TAIL	EA	R175.82
10511-52-20	(38S) M52 METRIC M X 2 X 1 1/4 TAIL	EA	R228.03

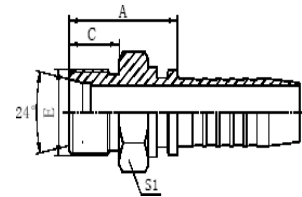

Metric Female Hose Fittings (Light Series) – Straight			
20411-12-04	(6L) M12 METRIC F X 1.5 X 1/4 TAIL	EA	R24.69
20411-14-04	(8L) M14 METRIC F X 1.5 X 1/4 TAIL	EA	R26.59
20411-16-04	(10L) M16 METRIC F X 1.5 X 1/4 TAIL	EA	R29.68
20411-16-05	(10L)M16 METRIC F X 1.5 X 5/16 TAIL	EA	R27.83
20411-16-06	(10L) M16 METRIC F X 1.5 X 3/8 TAIL	EA	R33.42
20411-18-04	(12L) M18 METRIC F X 1.5 X 1/4 TAIL	EA	R32.51
20411-18-05	(12L) M18 METRIC F X 1.5 X 5/16 TAIL	EA	R33.36
20411-18-06	(12L) M18 METRIC F X 1.5 X 3/8 TAIL	EA	R34.38
20411-22-06	(15L) M22 METRIC F X 1.5 X 3/8 TAIL	EA	R40.70
20411-22-08	(15L) M22 METRIC F X 1.5 X 1/2 TAIL	EA	R41.62
20411-26-08	(18L) M26 METRIC F X 1.5 X 1/2 TAIL	EA	R61.28
20411-26-10	(18L) M26 METRIC F X 1.5 X 5/8 TAIL	EA	R63.55
20411-30-10	(22L) M30 METRIC F X 2 X 5/8 TAIL	EA	R75.65
20411-30-12	(22L) M30 METRIC F X 2 X 3/4 TAIL	EA	R73.67
20411-36-16	(28L) M36 METRIC F X 2 X 1 TAIL	EA	R125.67
20411-45-20	(35L) M45 METRIC F X 2 X 1 1/4 TAIL	EA	R214.77
20411-52-24	(42L) M52 METRIC F X 2 X 1 1/2 TAIL	EA	R295.14
Metric Female Hose Fittings (Light Series) - 45 Degree			
20441-12-04	(6L) M12 METRIC F X 1.5 X 1/4 TAIL 45	EA	R25.57
20441-14-04	(8L) M14 METRIC F X 1.5 X 1/4 TAIL 45	EA	R27.68
20441-16-04	(10L) M16 METRIC F X 1.5 X 1/4 TAIL 45	EA	R34.85
20441-16-06	(10L) M16 METRIC F X 1.5 X 3/8 TAIL 45	EA	R45.62
20441-18-06	(12L) M18 METRIC F X 1.5 X 3/8 TAIL 45	EA	R41.43
20441-22-08	(15L) M22 METRIC F X 1.5 X 1/2 TAIL 45	EA	R53.86
20441-26-10	(18L) M26 METRIC F X 1.5 X 5/8 TAIL 45	EA	R91.54
20441-30-12	(22L) M30 METRIC F X 2 X 3/4 TAIL 45	EA	R115.69
20441-36-16	(28L) M36 METRIC F X 2 X 1 TAIL 45	EA	R158.40
20441-45-20	(35L) M45 METRIC F X 2 X 1 1/4 TAIL 45	EA	R339.02

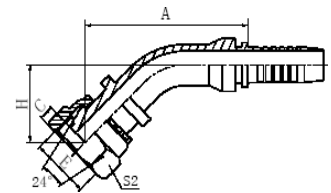
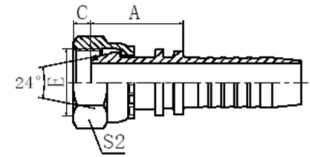

Metric Female Hose Fittings (Light Series) - 90 Degree			
20491-12-04	(6L) M12 METRIC F X 1.5 X 1/4 TAIL 90	EA	R37.84
20491-14-04	(8L) M14 METRIC F X 1.5 X 1/4 TAIL 90	EA	R37.84
20491-16-04	(10L) M16 METRIC F X 1.5 X 1/4 TAIL 90	EA	R46.15
20491-16-05	(10L) M16 METRIC F X 1.5 X 5/16 TAIL 90	EA	R47.63
20491-16-06	(10L) M16 METRIC F X 1.5 X 3/8 TAIL 90	EA	R46.15
20491-18-04	(12L) M18 METRIC F X 1.5 X 1/4 TAIL 90	EA	R53.28
20491-18-06	(12L) M18 METRIC F X 1.5 X 3/8 TAIL 90	EA	R54.98
20491-22-06	(15L) M22 METRIC F X 1.5 X 3/8 TAIL 90	EA	R60.84
20491-22-08	(15L) M22 METRIC F X 1.5 X 1/2 TAIL 90	EA	R66.99
20491-26-08	(18L) M26 METRIC F X 1.5 X 1/2 TAIL 90	EA	R88.08
20491-26-10	(18L) M26 METRIC F X 1.5 X 5/8 TAIL 90	EA	R97.79
20491-30-12	(22L) M30 METRIC F X 2 X 3/4 TAIL 90	EA	R137.61
20491-36-16	(28L) M36 METRIC F X 2 X 1 TAIL 90	EA	R203.97
20491-45-20	(35L) M45 METRIC F X 2 X 1 1/4 TAIL 90	EA	R343.46
20491-52-24	(42L) M52 METRIC F X 2 X 1 1/2 TAIL 90	EA	R444.66
Karcher Female Hose Fittings			
20011-22-04	M22 x 1.5 x 1/4 KARCHER FITTING	EA	R81.19
20011-22-05	M22 x 1.5 x 5/16 TAIL KARCHER FITTING	EA	R81.19
20011-22-06	M22 x 1.5 x 3/8 TAIL KARCHER FITTING	EA	R91.17
Metric Female Hose Fittings (Heavy Series) – Straight			
20511-14-04	(6S) M14 METRIC F X 1.5 X 1/4 TAIL	EA	R30.50
20511-16-04	(8S) M16 METRIC F X 1.5 X 1/4 TAIL	EA	R31.94
20511-18-04	(10S) M18 METRIC F X 1.5 X 1/4 TAIL	EA	R35.45
20511-18-06	(10S) M18 METRIC F X 1.5 X 3/8 TAIL	EA	R42.86
20511-20-04	(12S) M20 METRIC F X 1.5 X 1/4 TAIL	EA	R45.21
20511-20-06	(12S) M20 METRIC F X 1.5 X 3/8 TAIL	EA	R45.21
20511-22-06	(14S) M22 METRIC F X 1.5 X 3/8 TAIL	EA	R44.92
20511-24-08	(16S) M24 METRIC F X 1.5 X 1/2 TAIL	EA	R56.90
20511-30-10	(20S) M30 METRIC F X 2 X 5/8 TAIL	EA	R87.70
20511-30-12	(20S) M30 METRIC F X 2 X 3/4 TAIL	EA	R105.55
20511-36-12	(25S) M36 METRIC F X 2 X 3/4 TAIL	EA	R120.30
20511-36-16	(25S) M36 METRIC F X 2 X 1 TAIL	EA	R131.47
20511-42-16	(30S) M42 METRIC F X 2 X 1 TAIL	EA	R185.50
20511-52-20	(38S) M52 METRIC F X 2 X 1 1/4 TAIL	EA	R266.38
20513-36-12	(25S) M36 F X 2 X 3/4 TAIL INTERLOCK	EA	R203.39
20513-42-16	(30S) M42 F X 2 X 1 TAIL INTERLOCK	EA	R243.73
20513-42-20	(30S) M42 F X 2 X 1 1/4 TAIL INTERLOCK	EA	R292.42
20513-52-20	(38S) M52 F X 2 X 1 1/4 TAIL INTERLOCK	EA	R359.88

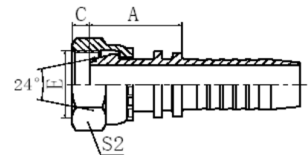
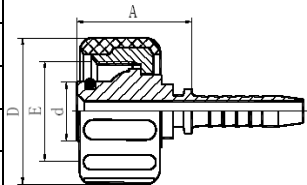

20513-52-24	(38S) M52 F X 2 X 1 1/2 TAIL INTERLOCK	EA	R485.06
Metric Female Hose Fittings (Heavy Series) - 45 Degree			
20541-18-04	(10S) M18 METRIC F X 1.5 X 1/4 TAIL 45	EA	R49.12
20541-20-06	(12S) M20 METRIC F X 1.5 X 3/8 TAIL 45	EA	R57.82
20541-22-06	(14S) M22 METRIC F X 1.5 X 3/8 TAIL 45	EA	R63.06
20541-24-08	(16S) M24 METRIC F X 1.5 X 1/2 TAIL 45	EA	R70.02
20541-30-10	(20S) M30 METRIC F X 2 X 5/8 TAIL 45	EA	R116.90
20541-36-12	(25S) M36 METRIC F X 2 X 3/4 TAIL 45	EA	R155.29
20541-42-16	(30S) M42 METRIC F X 2 X 1 TAIL 45	EA	R198.10
20541-52-20	(38S) M52 METRIC F X 2 X 1 1/4 TAIL 45	EA	R387.48
Metric Female Hose Fittings (Heavy Series) - 90 Degree			
20591-16-04	(8S) M16 METRIC F X 1.5 X 1/4 TAIL 90	EA	R47.52
20591-18-04	(10S) M18 METRIC F X 1.5 X 1/4 TAIL 90	EA	R54.13
20591-20-06	(12S) M20 METRIC F X 1.5 X 3/8 TAIL 90	EA	R57.66
20591-22-06	(14S) M22 METRIC F X 1.5 X 3/8 TAIL 90	EA	R59.51
20591-24-08	(16S) M24 METRIC F X 1.5 X 1/2 TAIL 90	EA	R75.72
20591-30-10	(20S) M30 METRIC F X 1.5 X 5/8 TAIL 90	EA	R126.08
20591-30-12	(20S) M30 METRIC F X 1.5 X 3/4 TAIL 90	EA	R140.50
20591-36-12	(25S) M36 METRIC F X 1.5 X 3/4 TAIL 90	EA	R165.89
20591-36-16	(25S) M36 METRIC F X 1.5 X 1 TAIL 90	EA	R175.36
20591-42-16	(30S) M42 METRIC F X 1.5 X 1 TAIL 90	EA	R246.62
20591-52-20	(38S) M52 METRIC F X 1.5 X 1 1/4 TAIL 90	EA	R427.19
20593-36-12	(25S) M36 F X 2 X 3/4 TAIL INTERLOCK	EA	R267.38
20593-42-16	(30S) M42 F X 2 X 1 TAIL INTERLOCK	EA	R343.94
20593-52-20	(38S) M52 F X 2 X 1 1/4 TAIL INTERLOCK	EA	R561.32
BSP Male Hose Fittings			
12611A-02-04	1/8 BSPP M X 1/4 TAIL	EA	R20.16
12611A-04-04	1/4 BSPP M X 1/4 TAIL	EA	R22.86
12611A-04-06	1/4 BSPP M X 3/8 TAIL	EA	R26.14
12611A-06-04	3/8 BSPP M X 1/4 TAIL	EA	R30.62
12611A-06-06	3/8 BSPP M X 3/8 TAIL	EA	R28.39
12611A-08-06	1/2 BSPP M X 3/8 TAIL	EA	R41.76
12611A-08-08	1/2 BSPP M X 1/2 TAIL	EA	R45.51
12611A-10-10	5/8 BSPP M X 5/8 TAIL	EA	R57.35
12611A-12-08	3/4 BSPP M X 1/2 TAIL	EA	R61.71
12611A-12-12	3/4 BSPP M X 3/4 TAIL	EA	R75.20
12611A-16-12	1 BSPP M X 3/4 TAIL	EA	R115.57
12611A-16-16	1 BSPP M X 1 TAIL	EA	R137.81
12611A-20-20	1 1/4 BSPP M X 1 1/4 TAIL	EA	R167.38

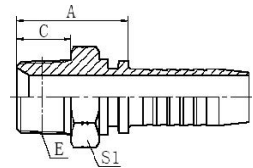
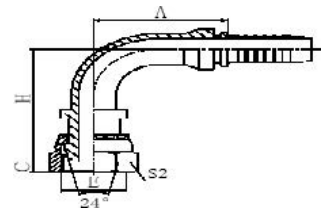
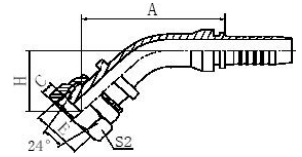

12611A-24-24	1 1/2 BSPP M X 1 1/2 TAIL	EA	R231.17
12611A-32-32	2 BSPP M X 2 TAIL	EA	R586.51
BSP Flat Face Female Hose Fittings			
22211-06-06	3/8 BSPP FLAT FACE X 3/8 TAIL	EA	R25.47
22211-08-06	1/2 BSPP FLAT FACE X 3/8 TAIL	EA	R43.77
22211-08-08	1/2 BSPP FLAT FACE X 1/2 TAIL	EA	R40.66
22211-12-08	3/4 BSPP FLAT FACE X 1/2 TAIL	EA	R67.32
22211-12-12	3/4 BSPP FLAT FACE X 3/4 TAIL	EA	R68.43
BSP Female Hose Fittings – Straight			
22611-02-04	1/8 BSPP F X 1/4 TAIL	EA	R27.88
22611-04-04	1/4 BSPP F X 1/4 TAIL	EA	R16.47
22611-04-06	1/4 BSPP F X 3/8 TAIL	EA	R28.81
22611-06-04	3/8 BSPP F X 1/4 TAIL	EA	R28.81
22611-06-06	3/8 BSPP F X 3/8 TAIL	EA	R29.62
22611-06-08	3/8 BSPP X 1/2 TAIL	EA	R42.64
22611-08-06	1/2 BSPP F X 3/8 TAIL	EA	R35.64
22611-08-08	1/2 BSPP F X 1/2 TAIL	EA	R39.42
22611-10-08	5/8 BSPP F X 1/2 TAIL	EA	R47.20
22611-10-10	5/8 BSPP F X 5/8 TAIL	EA	R54.02
22611-12-08	3/4 BSPP F X 1/2 TAIL	EA	R60.77
22611-12-10	3/4 BSPP F X 5/8 TAIL	EA	R67.01
22611-12-12	3/4 BSPP F X 3/4 TAIL	EA	R60.05
22611-16-12	1 BSPP F X 3/4 TAIL	EA	R94.71
22611-16-16	1 BSPP F X 1 TAIL	EA	R97.27
22611-20-16	1 1/4 BSPP F X 1 TAIL	EA	R182.11
22611-20-20	1 1/4 BSPP F X 1 1/4 TAIL	EA	R194.46
22611-24-24	1 1/2 BSPP F X 1 1/2 TAIL	EA	R231.63
22611-32-32	2 BSPP F X 2 TAIL	EA	R411.85
22613-12-12	3/4 BSPP F x 3/4 TAIL INTERLOCK	EA	R153.71
22613-16-16	1 BSPP F x 1 TAIL INTERLOCK	EA	R167.90
22613-20-20	1 1/4 BSPP F X 1 1/4 TAIL INTERLOCK	EA	R396.00
BSP Female Hose Fittings - 45 Degree			
22641-04-04	1/4 BSPP F X 1/4 TAIL 45	EA	R37.86
22641-06-04	3/8 BSPP F X 1/4 TAIL 45	EA	R39.95
22641-06-06	3/8 BSPP F X 3/8 TAIL 45	EA	R44.25
22641-08-06	1/2 BSPP F X 3/8 TAIL 45	EA	R59.61
22641-08-08	1/2 BSPP F X 1/2 TAIL 45	EA	R62.09
22641-10-08	5/8 BSPP F X 1/2 TAIL 45	EA	R80.43
22641-10-10	5/8 BSPP F X 5/8 TAIL 45	EA	R83.71

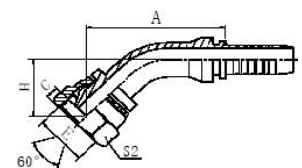
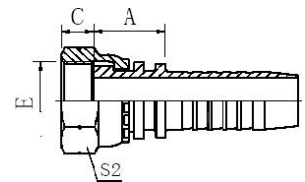
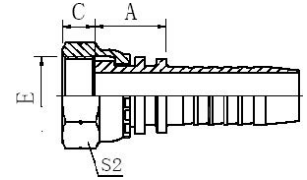

22641-12-08	3/4 BSPP F X 1/2 TAIL 45	EA	R91.73
22641-12-12	3/4 BSPP F X 3/4 TAIL 45	EA	R97.29
22641-16-16	1 BSPP F X 1 TAIL 45	EA	R153.56
22641-20-20	1 1/4 BSPP F X 1 1/4 TAIL 45	EA	R251.28
22641-24-24	1 1/2 BSPP F X 1 1/2 TAIL 45	EA	R379.90
22641-32-32	2 BSPP F X 2 TAIL 45	EA	R720.39
BSP Female Hose Fittings - 90 Degree			
22691-02-04	1/8 BSPP F X 1/4 TAIL 90	EA	R36.48
22691-04-04	1/4 BSPP F X 1/4 TAIL 90	EA	R43.23
22691-06-04	3/8 BSPP F X 1/4 TAIL 90	EA	R44.40
22691-06-06	3/8 BSPP F X 3/8 TAIL 90	EA	R44.61
22691-08-06	1/2 BSPP F X 3/8 TAIL 90	EA	R59.05
22691-08-08	1/2 BSPP F X 1/2 TAIL 90	EA	R66.25
22691-10-08	5/8 BSPP F X 1/2 TAIL 90	EA	R94.88
22691-10-10	5/8 BSPP F X 5/8 TAIL 90	EA	R88.18
22691-12-12	3/4 BSPP F X 3/4 TAIL 90	EA	R105.45
22691-16-12	1 BSPP F X 3/4 TAIL 90	EA	R166.01
22691-16-16	1 BSPP F X 1 TAIL 90	EA	R166.01
22691-20-20	1 1/4 BSPP F X 1 1/4 TAIL 90	EA	R299.06
22691-24-24	1 1/2 BSPP F X 1 1/2 TAIL 90	EA	R393.32
22691-32-32	2 BSPP F X 2 TAIL 90	EA	R825.88
22693-16-16	1 BSP F X 1 TAIL INTERLOCK 90	EA	R369.16
22693-20-20	1 1/4 BSPP F X 1 1/4 TAIL INTERLOCK 90	EA	R668.85
BSP Female Hose Fittings - 90 Degree (Compact)			
22691K-04-04	1/4 BSPP F X 1/4 TAIL COMPACT	EA	R42.61
22691K-06-06	3/8 BSPP F X 3/8 TAIL COMPACT	EA	R61.11
22691K-08-08	1/2 BSPP F X 1/2 TAIL COMPACT	EA	R90.64
22691K-12-12	3/4 BSPP F X 3/4 TAIL COMPACT	EA	R143.09
ORFS Male Hose Fittings			
14211-04-04	9/16 ORFS M X 1/4 TAIL	EA	R27.98
14211-06-04	11/16 ORFS M X 1/4 TAIL	EA	R36.37
14211-06-06	11/16 ORFS M X 3/8 TAIL	EA	R31.43
14211-08-06	13/16 ORFS M X 3/8 TAIL	EA	R44.55
14211-08-08	13/16 ORFS M X 1/2 TAIL	EA	R39.00
14211-10-08	1-14 ORFS M X 1/2 TAIL	EA	R50.21
14211-10-10	1-14 ORFS M X 5/8 TAIL	EA	R44.28
14211-12-08	1 3/16 ORFS M X 1/2 TAIL	EA	R88.92
14211-12-10	1 3/16 ORFS M X 5/8 TAIL	EA	R69.41
14211-12-12	1 3/16 ORFS M X 3/4 TAIL	EA	R69.41

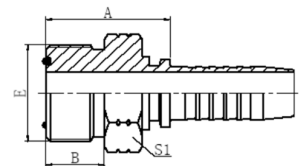
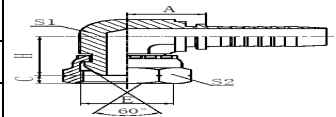
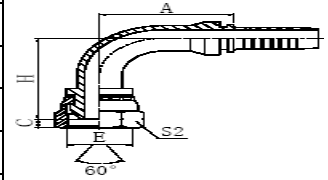

14211-16-12	1 7/16 ORFS M X 3/4 TAIL	EA	R132.49
14211-16-16	1 7/16 ORFS M X 1 TAIL	EA	R122.08
ORFS Female Hose Fittings – Straight			
24211-04-04	9/16 ORFS F X 1/4 TAIL	EA	R25.34
24211-06-04	11/16 ORFS F X 1/4 TAIL	EA	R31.82
24211-06-06	11/16 ORFS F X 3/8 TAIL	EA	R31.82
24211-08-06	13/16 ORFS F X 3/8 TAIL	EA	R41.35
24211-08-08	13/16 ORFS F X 1/2 TAIL	EA	R41.35
24211-10-08	1-14 ORFS F X 1/2 TAIL	EA	R60.72
24211-10-10	1-14 ORFS F X 5/8 TAIL	EA	R57.02
24211-12-08	1 3/16 ORFS F X 1/2 TAIL	EA	R101.38
24211-12-10	1 3/16 ORFS F X 5/8 TAIL	EA	R74.06
24211-12-12	1 3/16 ORFS F X 3/4 TAIL	EA	R74.06
24211-16-12	1 7/16 ORFS F X 3/4 TAIL	EA	R119.53
24211-16-16	1 7/16 ORFS F X 1 TAIL	EA	R115.76
24211-20-20	1 11/16 ORFS F X 1 1/4 TAIL	EA	R202.84
24211-24-24	2 ORFS F X 1 1/2 TAIL	EA	R287.97
24213-12-12	1 3/16 ORFS F X 3/4 TAIL INTERLOCK	EA	R118.98
24213-16-16	1 7/16 ORFS F x 1 TAIL INTERLOCK	EA	R268.66
24213-20-20	1 11/16 ORFS F x 1 1/4 TAIL INTERLOCK	EA	R384.08
ORFS Female Hose Fittings - 45 Degree			
24241-04-04	9/16 ORFS F X 1/4 TAIL 45	EA	R48.11
24241-06-04	11/16 ORFS F X 1/4 TAIL 45	EA	R60.07
24241-06-06	11/16 ORFS F X 3/8 TAIL 45	EA	R52.52
24241-08-06	13/16 ORFS F X 3/8 TAIL 45	EA	R76.38
24241-08-08	13/16 ORFS F X 1/2 TAIL 45	EA	R60.77
24241-10-08	1-14 ORFS F X 1/2 TAIL 45	EA	R96.31
24241-10-10	1-14 ORFS F X 5/8 TAIL 45	EA	R94.56
24241-12-08	1 3/16 ORFS F X 1/2 TAIL 45	EA	R134.69
24241-12-10	1 3/16 ORFS F X 5/8 TAIL 45	EA	R160.51
24241-12-12	1 3/16 ORFS F X 3/4 TAIL 45	EA	R106.37
24241-16-16	1 7/16 ORFS F X 1 TAIL 45	EA	R203.51
24241-20-20	1 11/16 ORFS F X 1 1/4 TAIL 45	EA	R314.35
24241-24-24	2 ORFS F X 1 1/2 TAIL 45	EA	R466.75
ORFS Female Hose Fittings - 90 Degree			
24291-04-04	9/16 ORFS F X 1/4 TAIL 90	EA	R35.32
24291-06-04	11/16 ORFS F X 1/4 TAIL 90	EA	R62.67
24291-06-06	11/16 ORFS F X 3/8 TAIL 90	EA	R49.68
24291-08-06	13/16 ORFS F X 3/8 TAIL	EA	R62.62

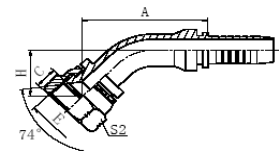
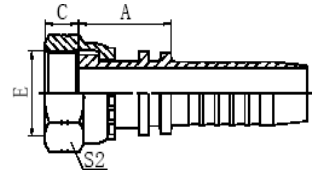

24291-08-08	13/16 ORFS F X 1/2 TAIL 90	EA	R60.93
24291-10-08	1-14 ORFS F X 1/2 TAIL 90	EA	R118.57
24291-10-10	1-14 ORFS F X 5/8 TAIL 90	EA	R142.38
24291-12-08	1 3/16 ORFS F X 1/2 TAIL 90	EA	R167.38
24291-12-10	1 3/16 ORFS F X 5/8 TAIL 90	EA	R181.90
24291-12-12	1 3/16 ORFS F X 3/4 TAIL 90	EA	R110.99
24291-16-12	1 7/16 ORFS F X 3/4 TAIL 90	EA	R242.67
24291-16-16	1 7/16 ORFS F X 1 TAIL 90	EA	R242.67
24291-20-20	1 11/16 ORFS F X 1 1/4 TAIL 90	EA	R355.87
24291-24-24	2 ORFS F X 1 1/2 TAIL 90	EA	R517.87
24293-12-12	1 3/16 ORFS F X 3/4 TAIL INTERLOCK 90	EA	R188.24
24293-16-16	1 7/16 ORFS F X 1 TAIL INTERLOCK 90	EA	R336.43
24293-20-20	1 11/16 ORFS F X 1 1/4 TAIL INTERLOCK 90	EA	R637.63
NPT Male Hose Fittings			
15611-02-04	1/8 NPT M X 1/4 TAIL	EA	R19.32
15611-04-04	1/4 NPT M X 1/4 TAIL	EA	R22.98
15611-04-06	1/4 NPT M X 3/8 TAIL	EA	R25.29
15611-06-04	3/8 NPT M X 1/4 TAIL	EA	R26.24
15611-06-05	3/8 NPT M X 5/16 TAIL	EA	R31.36
15611-06-06	3/8 NPT M X 3/8 TAIL	EA	R27.46
15611-06-08	3/8 NPT M X 1/2 TAIL	EA	R32.95
15611-08-06	1/2 NPT M X 3/8 TAIL	EA	R37.40
15611-08-08	1/2 NPT M X 1/2 TAIL	EA	R31.35
15611-08-12	1/2 NPT M X 3/4 TAIL	EA	R64.24
15611-12-08	3/4 NPT M X 1/2 TAIL	EA	R69.45
15611-12-10	3/4 NPT M X 5/8 TAIL	EA	R47.71
15611-12-12	3/4 NPT M X 3/4 TAIL	EA	R56.43
15611-12-16	3/4 NPT MALE X 1 TAIL	EA	R92.08
15611-16-12	1 NPT M X 3/4 TAIL	EA	R106.19
15611-16-16	1 NPT M X 1 TAIL	EA	R106.19
15611-20-20	1 1/4 NPT M X 1 1/4 TAIL	EA	R202.89
15611-24-24	1 1/2 NPT M X 1 1/2 TAIL	EA	R263.11
15611-32-32	2 NPT M X 2 TAIL	EA	R537.31
15613-16-16	1 NPT M INTERLOCK X 1 TAIL	EA	R205.80
15613-20-20	1 1/4 NPT M INTERLOCK X 1 1/4 TAIL	EA	R228.42
NPT Swivel Male Hose Fittings			
15611SW-04-04	1/4 NPT M SWIVEL X 1/4 TAIL	EA	R72.25
15611SW-06-06	3/8 NPT M SWIVEL X 3/8 TAIL	EA	R95.15
15611SW-08-08	1/2 NPT M SWIVEL X 1/2 TAIL	EA	R108.39

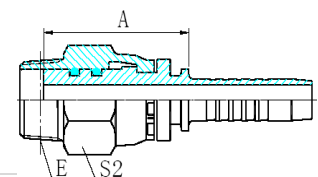
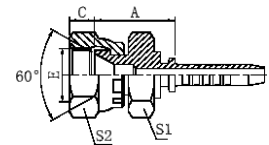
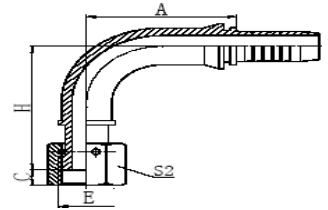

JIC Male Hose Fittings			
16711-04-04	7/16 JIC M X 1/4 TAIL	EA	R21.54
16711-05-04	1/2-20 JIC M X 1/4 TAIL	EA	R21.54
16711-06-04	9/16 JIC M X 1/4 TAIL	EA	R26.73
16711-06-06	9/16 JIC M X 3/8 TAIL	EA	R23.23
16711-08-06	3/4-16 JIC M X 3/8 TAIL	EA	R37.17
16711-08-08	3/4-16 JIC M X 1/2 TAIL	EA	R37.17
16711-10-06	1/8 JIC M X 3/8 TAIL	EA	R43.88
16711-10-08	7/8 JIC M X 1/2 TAIL	EA	R44.14
16711-10-10	7/8 JIC M X 5/8 TAIL	EA	R48.64
16711-12-08	1 1/16 JIC M X 1/2 TAIL	EA	R76.44
16711-12-10	1 1/16 JIC M X 5/8 TAIL	EA	R76.44
16711-12-12	1 1/16 JIC M X 3/4 TAIL	EA	R65.96
16711-14-12	1 3/16 JIC M X 3/4 TAIL	EA	R103.40
16711-16-12	1 5/16 JIC M X 3/4 TAIL	EA	R99.21
16711-16-16	1 5/16 JIC M X 1 TAIL	EA	R133.42
16711-20-20	1 5/8 JIC M X 1 1/4 TAIL	EA	R219.80
16711-24-24	1 7/8 JIC M X 1 1/2 TAIL	EA	R402.86
16711-32-32	2 1/2 JIC M X 2 TAIL	EA	540.09
SAE Male Hose Fittings			
17811-06-06	5/8-18 SAE M X 3/8 TAIL	EA	27.29
JIC Female Hose Fittings – Straight			
26711-04-04	7/16 JIC F X 1/4 TAIL	EA	19.02
26711-05-04	1/2-20 JIC F X 1/4 TAIL	EA	20.80
26711-05-05	1/2-20 JIC F X 5/16 TAIL	EA	22.97
26711-06-04	9/16 JIC F X 1/4 TAIL	EA	21.74
26711-06-05	9/16 JIC F X 5/16 TAIL	EA	17.78
26711-06-06	9/16 JIC F X 3/8 TAIL	EA	R27.60
26711-08-06	3/4-16 JIC F X 3/8 TAIL	EA	R29.80
26711-08-08	3/4-16 JIC F X 1/2 TAIL	EA	R35.70
26711-10-06	7/8 JIC F X 3/8 TAIL	EA	R44.83
26711-10-08	7/8 JIC F X 1/2 TAIL	EA	R48.00
26711-10-10	7/8 JIC F X 5/8 TAIL	EA	R48.00
26711-12-08	1 1/16 JIC F X 1/2 TAIL	EA	R64.28
26711-12-10	1 1/16 JIC F X 5/8 TAIL	EA	R64.48
26711-12-12	1 1/16 JIC F X 3/4 TAIL	EA	R54.82
26711-16-12	1 5/16 JIC F X 3/4 TAIL	EA	R109.58
26711-16-16	1 5/16 JIC F X 1 TAIL	EA	R95.60
26711-20-16	1 5/8 JIC F X 1 TAIL	EA	R148.24

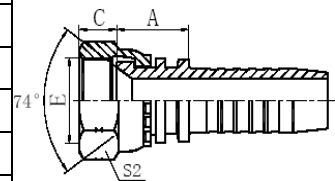
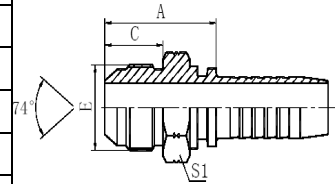

26711-20-20	1 5/8 JIC F X 1 1/4 TAIL	EA	R160.88
26711-24-20	1 7/8 JIC F X 1 1/4 TAIL	EA	R227.85
26711-24-24	1 7/8 JIC F X 1 1/2 TAIL	EA	R235.60
26711-32-32	2 1/2 JIC F X 2 TAIL	EA	R430.95
26713D-12-12	1 1/16 JIC F X 3/4 TAIL INTERLOCK	EA	R168.43
26713D-16-16	1 5/16 JIC F X 1 TAIL INTERLOCK	EA	R252.32
26713D-20-20	1 5/8 JIC F X 1 1/4 TAIL INTERLOCK	EA	R390.46
JIC Female Hose Fittings - 45 Degree			
26741-04-04	7/16 JIC F X 1/4 TAIL 45	EA	R39.65
26741-05-04	1/2-20 JIC F X 1/4 TAIL 45	EA	R42.93
26741-06-04	9/16 JIC F X 1/4 TAIL 45	EA	R49.44
26741-06-06	9/16 JIC F X 3/8 TAIL 45	EA	R49.52
26741-08-06	3/4-16 JIC F X 3/8 TAIL 45	EA	R65.07
26741-08-08	3/4-16 JIC F X 1/2 TAIL 45	EA	R63.85
26741-10-08	7/8 JIC F X 1/2 TAIL 45	EA	R77.74
26741-10-10	7/8 JIC F X 5/8 TAIL	EA	R95.39
26741-12-10	1 1/16 JIC F X 5/8 45	EA	R106.50
26741-12-12	1 1/16 JIC F X 3/4 TAIL 45	EA	R117.74
26741-16-16	1 5/16 JIC F X 1 TAIL 45	EA	R150.27
26741-20-20	1 5/8 JIC F X 1 1/4 TAIL 45	EA	R321.90
26741-24-24	1 7/8 JIC F X 1 1/2 TAIL 45	EA	R493.50
26741-32-32	2 1/2 JIC F X 2 TAIL 45	EA	R871.73
26743-16-16	1 5/16 F X 1 TAIL INTERLOCK 45	EA	R323.80
26743-20-20	1 5/8 JIC F X 1 1/4 TAIL INTERLOCK 45	EA	R472.26
JIC Female Hose Fittings - 90 Degree			
26791-04-04	7/16 JIC F X 1/4 TAIL 90	EA	R32.62
26791-05-04	1/2-20 JIC F X 1/4 TAIL 90	EA	R38.23
26791-06-04	9/16 JIC F X 1/4 TAIL 90	EA	R50.37
26791-06-06	9/16 JIC F X 3/8 TAIL 90	EA	R49.37
26791-08-06	3/4-16 JIC F X 3/8 TAIL 90	EA	R68.32
26791-08-08	3/4-16 JIC F X 1/2 TAIL 90	EA	R62.56
26791-10-08	7/8 JIC F X 1/2 TAIL 90	EA	R81.80
26791-10-10	7/8 JIC F X 5/8 TAIL 90	EA	R98.03
26791-12-08	1 1/16 JIC F X 1/2 TAIL 90	EA	R110.14
26791-12-10	1 1/16 JIC F X 5/8 TAIL 90	EA	R113.87
26791-12-12	1 1/16 JIC F X 3/4 TAIL 90	EA	R106.98
26791-16-12	1 5/16 JIC F X 3/4 TAIL 90	EA	R192.30
26791-16-16	1 5/16 JIC F X 1 TAIL 90	EA	R199.86
26791-20-20	1 5/8 JIC F X 1 1/4 TAIL 90	EA	R266.65

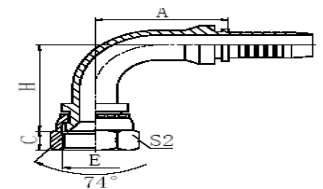
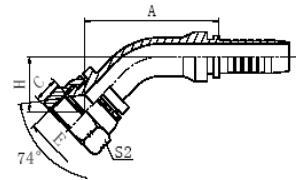

26791-24-20	1 7/8 JIC F X 1 1/4 TAIL 90	EA	R417.32
26791-24-24	1 7/8 JIC F X 1 1/2 TAIL 90	EA	R409.15
26791-32-32	2 1/2 JIC F X 2 TAIL 90	EA	R773.24
26793-12-12	1 1/16 X 3/4 TAIL INTERLOCK 90	EA	R247.84
26793-16-16	1 5/16 JIC F X 1 TAIL INTERLOCK 90	EA	R293.30
26793-20-20	1 5/8 JIC F X 1 1/4 TAIL INTERLOCK 90	EA	R605.11
JIC Female Hose Fittings - 90 Degree (Compact)			
26791K-04-04	7/16 JIC F X 1/4 TAIL COMPACT 90	EA	R49.21
26791K-06-06	9/16 JIC F X 3/8 TAIL COMPACT 90	EA	R62.16
26791K-08-08	3/4-16 JIC F X 1/2 TAIL COMPACT 90	EA	R90.64
26791K-12-12	1 1/16 JIC F X 3/4 TAIL COMPACT 90	EA	R116.21

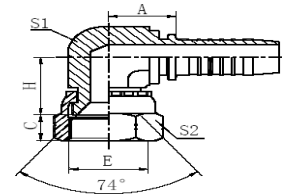

SAE Female Hose Fittings			
27811-06-06	5/8-18 SAE F X 3/8 TAIL	EA	R30.26
27891-06-06	5/8-18 SAE F X 3/8 TAIL	EA	R49.00
Komatsu Female Hose Fittings			
28611-14-04	M14X1.5 KOM F X 1/4 TAIL	EA	R36.37
28611-16-05	M16X1.5 KOM F X 5/16 TAIL	EA	R44.29
28611-16-06	M16 KOM F X 1.5 X 3/8 TAIL	EA	R38.71
28611-18-06	M18X1.5 KOM F X 3/8 TAIL	EA	R51.15
28611-22-08	M22X1.5 KOM F X 1/2 TAIL	EA	R65.61
28611-24-10	M24X1.5 KOM F X 5/8 TAIL	EA	R89.96
28611-30-12	M30X1.5 KOM F X 3/4 TAIL	EA	R115.31
28611-33-16	M33X1.5 KOM F X 1 TAIL	EA	R152.31
28611-36-20	M36X1.5KOM F X 1 1/4 TAIL	EA	R174.84
28611-42-24	M42X1.5 KOM F X 1 1/2 TAIL	EA	R338.54
Komatsu Female Hose Fittings - 45 Degree			
28641-14-04	M14X1.5 KOM F X 1/4 TAIL 45	EA	R59.87
28641-18-06	M18X1.5 KOM F X 3/8 TAIL 45	EA	R79.87
28641-22-08	M22X1.5 KOM F X 1/2 TAIL 45	EA	R91.34
28641-24-10	M24X1.5 KOM F X 5/8 TAIL 45	EA	R119.55
28641-30-12	M30X1.5 KOM F X 3/4 TAIL 45	EA	R165.63
28641-33-16	M33X1.5 KOM F X 1 TAIL 45	EA	R260.71
Komatsu Female Hose Fittings - 90 Degree			
28691-14-04	M14X1.5 KOM F X 1/4 TAIL 90	EA	R55.38
28691-18-06	M18X1.5 KOM F X 3/8 TAIL 90	EA	R78.02
28691-22-08	M22X1.5 KOM F X 1/2 TAIL 90	EA	R94.71
28691-24-10	M24X1.5 KOM F X 5/8 TAIL 90	EA	R122.98
28691-30-12	M30 X 1.5 KOM F - 3/4 TAIL 90	EA	R167.55
JIS Female Hose Fittings			
29611-04-04	1/4 BSP (JIS) X 1/4 TAIL	EA	R37.58
29611-06-06	3/8 BSP (JIS) X 3/8 TAIL	EA	R49.48
29611-08-08	1/2 BSP (JIS) X 1/2 TAIL	EA	R64.06
29611-12-12	3/4 BSP (JIS) X 3/4 TAIL	EA	R91.99
29611-16-16	1 BSP (JIS) X 1 TAIL	EA	R157.41
Standpipes – Straight			
50011-06-04	6mm STANDPIPE X 1/4 TAIL	EA	R22.98
50011-08-04	8mm STANDPIPE X 1/4 TAIL	EA	R22.07
50011-10-04	10mm STANDPIPE X 1/4 TAIL	EA	R24.34
50011-10-06	10mm STANDPIPE X 3/8 TAIL	EA	R24.34
50011-12-04	12mm STANDPIPE X 1/4 TAIL	EA	R25.47

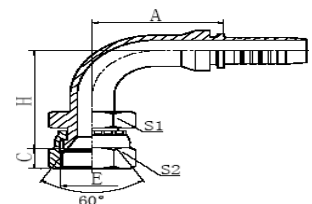
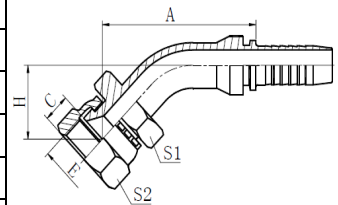
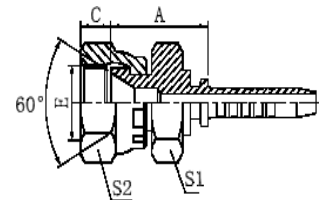

50011-12-06	12mm STANDPIPE X 3/8 TAIL	EA	R25.47
50011-12-08	12mm STANDPIPE X 1/2 TAIL	EA	R31.15
50011-14-06	14mm STANDPIPE X 3/8 TAIL	EA	R29.97
50011-15-08	15mm STANDPIPE X 1/2 TAIL	EA	R31.56
50011-16-08	16mm STANDPIPE X 1/2 TAIL	EA	R32.27
50011-18-08	18mm STANDPIPE X 1/2 TAIL	EA	R38.49
50011-18-10	18mm STANDPIPE X 5/8 TAIL	EA	R41.35
50011-20-10	20mm STANDPIPE X 5/8 TAIL	EA	R49.57
50011-20-12	20mm STANDPIPE X 3/4 TAIL	EA	R57.35
50011-22-12	22mm STANDPIPE X 3/4 TAIL	EA	R76.39
50011-25-12	25mm STANDPIPE X 3/4 TAIL	EA	R83.63
50011-25-16	25mm STANDPIPE X 1 TAIL	EA	R105.42
50011-28-16	28mm STANDPIPE X 1 TAIL	EA	R109.47
50011-30-16	30mm STANDPIPE X 1 TAIL	EA	R102.49
50011-35-20	35mm STANDPIPE X 1 1/4 TAIL	EA	R154.79
Standpipes - 90 Degree			
50091-06-04	6MM STANDPIPE X 1/4 TAIL 90	EA	R42.49
50091-08-04	8MM STANDPIPE X 1/4 TAIL 90	EA	R47.32
50091-10-04	10MM STANDPIPE X 1/4 TAIL 90	EA	R29.35
50091-10-06	10MM STANDPIPE X 3/8 TAIL 90	EA	R52.69
50091-12-06	12MM STANDPIPE X 3/8 TAIL 90	EA	R54.38
50091-15-08	15MM STANDPIPE X 1/2 TAIL 90	EA	R58.44
50091-16-08	16MM STANDPIPE X 1/2 TAIL 90	EA	R74.94
50091-18-10	18MM STANDPIPE X 5/8 TAIL 90	EA	R96.62
Metric Banjo Hose Fittings			
70011-10-04	M10 METRIC BANJO X 1/4 TAIL	EA	R27.88
70011-12-04	M12 METRIC BANJO X 1/4 TAIL	EA	R38.83
70011-14-04	M14 METRIC BANJO X 1/4 TAIL	EA	R50.05
70011-14-06	M14 METRIC BANJO X 3/8 TAIL	EA	R50.05
70011-16-06	M16 METRIC BANJO X 3/8 TAIL	EA	R69.80
70011-18-06	M18 METRIC BANJO X 3/8 TAIL	EA	R79.40
70011-18-08	M18 METRIC BANJO X 1/2 TAIL	EA	R79.40
70011-22-08	M22 METRIC BANJO X 1/2 TAIL	EA	R109.92
BSP Banjo Hose Fittings			
72011-02-04	1/8 BSPP BANJO X 1/4 TAIL	EA	R43.19
72011-04-04	1/4 BSPP BANJO X 1/4 TAIL	EA	R35.22
72011-06-06	3/8 BSPP BANJO X 3/8 TAIL	EA	R55.32
72011-08-08	1/2 BSPP BANJO X 1/2 TAIL	EA	R92.73
72011-12-12	3/4 BSPP BANJO X 3/4 TAIL	EA	R134.31

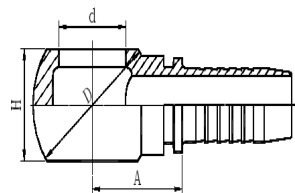
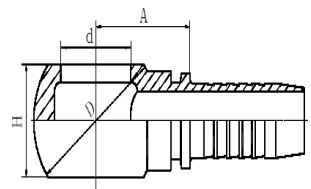
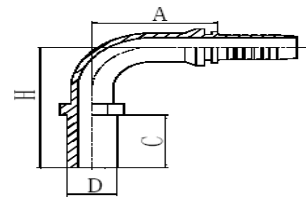
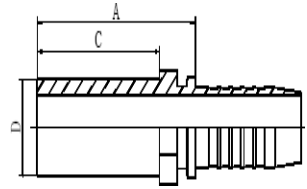

SAE Flange Hose Fittings (3000psi) – Straight			
87311-08-08	1/2 SAE FLANGE X 1/2 TAIL	EA	R65.52
87311-12-08	3/4 SAE FLANGE X 1/2 TAIL	EA	R108.73
87311-12-12	3/4 SAE FLANGE X 3/4 TAIL	EA	R109.94
87311-16-12	1 SAE FLANGE X 3/4 TAIL	EA	R139.60
87311-16-16	1 SAE FLANGE X 1 TAIL	EA	R110.84
87311-20-16	1 1/4 SAE FLANGE X 1 TAIL	EA	R217.11
87311-20-20	1 1/4 SAE FLANGE X 1 1/4 TAIL	EA	R241.81
87311-24-20	1 1/2 SAE FLANGE X 1 1/4 TAIL	EA	R322.96
87311-24-24	1 1/2 SAE FLANGE X 1 1/2 TAIL	EA	R322.89
87311-32-24	2 SAE FLANGE X 1 1/2 TAIL	EA	R469.54
87311-32-32	2 SAE FLANGE X 2 TAIL	EA	R586.43
87313-12-12	3/4 SAE FLANGE X 3/4 TAIL INTERLOCK	EA	R201.73
87313-16-12	1 SAE FLANGE X 3/4 TAIL INTERLOCK	EA	R226.23
87313-16-16	1 SAE FLANGE X 1 TAIL INTERLOCK	EA	R226.71
87313-20-16	1 1/4 SAE FLANGE X 1 TAIL INTERLOCK	EA	R346.47
87313-20-20	1 1/4 SAE FLANGE X 1 1/4 TAIL INTERLOC	EA	R334.96
87313-24-20	1 1/2 SAE FLANGE X 1 1/4 TAIL INTERLOC	EA	R408.45
87313-24-24	1 1/2 SAE FLANGE X 1 1/2 TAIL INTERLOC	EA	R408.45
SAE Flange Hose Fittings (3000psi) - 45 Degree			
87341-08-08	1/2 SAE FLANGE X 1/2 TAIL	EA	R77.04
87341-12-08	3/4 SAE FLANGE - 1/2 TAIL 45	EA	R133.26
87341-12-12	3/4 SAE FLANGE X 3/4 TAIL 45	EA	R124.56
87341-16-12	1 SAE FLANGE X 3/4 TAIL 45	EA	R220.89
87341-16-16	1 SAE FLANGE X 1 TAIL 45	EA	R191.97
87341-20-16	1 1/4 SAE FLANGE X 1 TAIL 45	EA	R286.74
87341-20-20	1 1/4 SAE FLANGE X 1 1/4 TAIL 45	EA	R302.49
87341-24-20	1 1/2 SAE FLANGE X 1 1/4 TAIL 45	EA	R387.46
87341-24-24	1 1/2 SAE FLANGE X 1 1/2 TAIL 45	EA	R432.03
87341-32-24	2 SAE FLANGE X 1 1/2 TAIL 45	EA	R725.80
87341-32-32	2 SAE FLANGE X 2 TAIL 45	EA	R645.32
87343-12-12	3/4 SAE FLANGE X 3/4 TAIL INTERLOCK 45	EA	R206.64
87343-16-12	1 SAE FLANGE X 3/4 TAIL INTERLOCK 45	EA	R364.92
87343-16-16	1 SAE FLANGE X 1 TAIL INTERLOCK 45	EA	R360.93
87343-20-20	1 1/4 SAE FLANGE X 1 1/4 TAIL INTERLOC	EA	R436.36
87343-24-20	1 1/2 SAE FLANGE X 1 1/4 TAIL INTERLOC	EA	R610.10
87343-24-24	1 1/2 SAE FLANGE X 1 1/2 TAIL INTERLOC	EA	R595.81
SAE Flange Hose Fittings (3000psi) - 90 Degree			
87391-08-08	1/2 SAE FLANGE X 1/2 TAIL 90	EA	R95.29

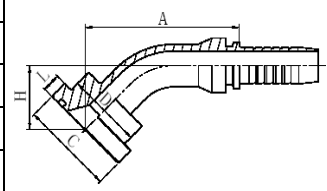
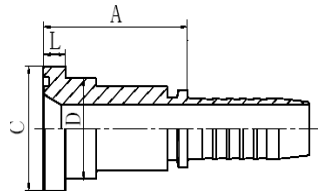

87391-12-08	3/4 SAE FLANGE X 1/2 TAIL 90	EA	R146.47
87391-12-12	3/4 SAE FLANGE X 3/4 TAIL 90	EA	R130.79
87391-16-12	1 SAE FLANGE X 3/4 TAIL 90	EA	R203.45
87391-16-16	1 SAE FLANGE X 1 TAIL 90	EA	R213.08
87391-20-16	1 1/4 SAE FLANGE X 1 TAIL 90	EA	R302.17
87391-20-20	1 1/4 SAE FLANGE X 1 1/4 TAIL 90	EA	R302.17
87391-24-20	1 1/2 SAE FLANGE X 1 1/4 TAIL 90	EA	R409.72
87391-24-24	1 1/2 SAE FLANGE X 1 1/2 TAIL 90	EA	R408.08
87391-32-24	2 SAE FLANGE X 1 1/2 TAIL 90	EA	R700.42
87391-32-32	2 SAE FLANGE X 2 TAIL 90	EA	R775.64
87393-12-12	3/4 SAE FLANGE X 3/4 TAIL INTERLOCK 90	EA	R229.42
87393-16-12	1 SAE FLANGE X 3/4 TAIL INTERLOCK 90	EA	R360.08
87393-16-16	1 SAE FLANGE X 1 TAIL INTERLOCK 90	EA	R360.08
87393-20-16	1 1/4 SAE FLANGE X 1 TAIL INTERLOCK 90	EA	R495.59
87393-20-20	1 1/4 SAE FLANGE X 1 1/4 TAIL INTERLOC	EA	R547.19
87393-24-20	1 1/2 SAE FLANGE X 1 1/4 TAIL INTERLOC	EA	R635.03
87393-24-24	1 1/2 SAE FLANGE X 1 1/2 TAIL INTERLOC	EA	R743.02
SAE Flange Hose Fittings (6000psi) – Straight			
87611-12-10	3/4 SAE FLANGE X 5/8 TAIL	EA	R163.18
87611-12-12	3/4 SAE FLANGE X 3/4 TAIL	EA	R149.07
87611-16-12	1 SAE FLANGE X 3/4 TAIL	EA	R153.02
87611-16-16	1 SAE FLANGE X 1 TAIL	EA	R183.26
87611-20-16	1 1/4 SAE FLANGE X 1 TAIL	EA	R263.67
87611-20-20	1 1/4 SAE FLANGE X 1 1/4 TAIL	EA	R263.67
87611-24-20	1 1/2 SAE FLANGE X 1 1/4 TAIL	EA	R308.54
87611-24-24	1 1/2 SAE FLANGE X 1 1/2 TAIL	EA	R333.21
87611-32-32	2 SAE FLANGE X 2 TAIL	EA	R589.62
87613-12-12	3/4 SAE FLANGE X 3/4 TAIL INTERLOCK	EA	R136.00
87613-16-12	1 SAE FLANGE X 3/4 TAIL INTERLOCK	EA	R262.84
87613-16-16	1 SAE FLANGE X 1 TAIL INTERLOCK	EA	R262.84
87613-20-16	1 1/4 SAE FLANGE X 1 1/4 TAIL INTERLOC	EA	R317.87
87613-20-20	1 1/4 SAE FLANGE X 1 1/4 TAIL INTERLOC	EA	R342.12
87613-24-20	1 1/2 SAE FLANGE X 1 1/4 TAIL INTERLOC	EA	R494.16
87613-24-24	1 1/2 SAE FLANGE X 1 1/2 TAIL INTERLOC	EA	R480.42
87613-32-32	2 SAE FLANGE X 2 TAIL INTERLOCK	EA	R623.06
SAE Flange Hose Fittings (6000psi) - 45 Degree			
87641-12-10	3/4 SAE FLANGE X 5/8 TAIL 45	EA	R167.33
87641-12-12	3/4 SAE FLANGE X 3/4 TAIL 45	EA	R154.97
87641-16-12	1 SAE FLANGE X 3/4 TAIL 45	EA	R210.86

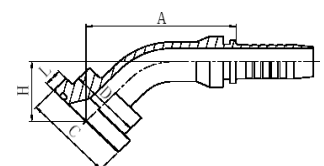
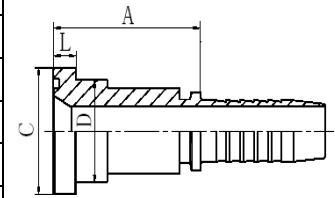
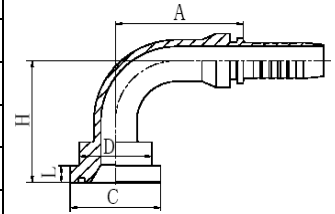

87641-16-16	1 SAE FLANGE X 1 TAIL 45	EA	R220.89
87641-20-16	1 1/4 SAE FLANGE X 1 TAIL 45	EA	R294.20
87641-20-20	1 1/4 SAE FLANGE X 1 1/4 TAIL 45	EA	R304.52
87641-24-20	1 1/2 SAE FLANGE X 1 1/4 TAIL 45	EA	R410.66
87641-24-24	1 1/2 SAE FLANGE X 1 1/2 TAIL 45	EA	R410.66
87641-32-32	2 SAE FLANGE X 2 TAIL 45	EA	R760.00
87643-12-12	3/4 SAE FLANGE X 3/4 TAIL INTERLOCK	EA	R249.71
87643-16-16	1 SAE FLANGE X 1 TAIL INTERLOCK 45	EA	R342.93
87643-20-16	1 1/4 SAE FLANGE X 1 TAIL INTERLOCK 45	EA	R461.16
87643-20-20	1 1/4 SAE FLANGE X 1 1/4 TAIL INTERLOC	EA	R523.12
87643-24-20	1 1/2 SAE FLANGE X 1 1/4 TAIL INTERLOCK	EA	R759.69
87643-24-24	1 1/2 SAE FLANGE X 1 1/2 TAIL INTERLOC	EA	R759.69
SAE Flange Hose Fittings (6000psi) - 90 Degree			
87691-12-10	3/4 SAE FLANGE X 5/8 TAIL	EA	R170.59
87691-12-12	3/4 SAE FLANGE X 3/4 TAIL 90	EA	R154.95
87691-16-12	1 SAE FLANGE X 3/4 TAIL 90	EA	R237.94
87691-16-16	1 SAE FLANGE X 1 TAIL 90	EA	R232.51
87691-20-16	1 1/4 SAE FLANGE X 1 TAIL 90	EA	R356.71
87691-20-20	1 1/4 SAE FLANGE X 1 1/4 TAIL 90	EA	R383.29
87691-24-20	1 1/2 SAE FLANGE X 1 1/4 TAIL 90	EA	R512.33
87691-24-24	1 1/2 SAE FLANGE X 1 1/2 TAIL 90	EA	R455.65
87691-32-24	2 SAE FLANGE X 1 1/2 TAIL 90	EA	R993.64
87691-32-32	2 SAE FLANGE X 2 TAIL 90	EA	R799.30
87693-12-12	3/4 SAE FLANGE X 3/4 TAIL INTERLOCK 90	EA	R262.78
87693-16-16	1 SAE FLANGE X 1 TAIL INTERLOCK 90	EA	R357.92
87693-20-16	1 1/4 SAE FLANGE X 1 TAIL INTERLOC	EA	R483.27
87693-20-20	1 1/4 SAE FLANGE X 1 1/4 TAIL INTERLOC	EA	R580.05
87693-24-20	1 1/2 SAE FLANGE X 1 1/4 TAIL INTERLOC	EA	R706.12
87693-24-24	1 1/2 SAE FLANGE X 1 1/2 TAIL INTERLOC	EA	R820.18
87693-32-32	2 SAE FLANGE X 2 TAIL INTERLOCK	EA	R1246.66
Komatsu Flange Hose Fittings			
88111-10-10	5/8 JIS (KOM) FLANGE X 5/8 TAIL	EA	R82.82
88141-10-10	5/8 JIS (KOM) FLANGE X 5/8 TAIL 45	EA	R137.56
88191-10-10	5/8 JIS (KOM) FLANGE X 5/8 TAIL 90	EA	R137.56
Hose Joiners			
90011-04	2W 1/4 HOSE JOINER	EA	R16.40
90011-05	2W 5/16 HOSE JOINER	EA	R19.17
90011-06	2W 3/8 HOSE JOINER	EA	R18.49
90011-08	2W 1/2 HOSE JOINER	EA	R25.93

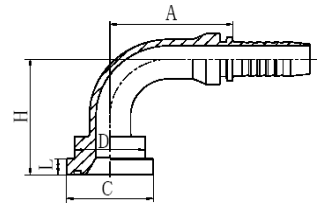

90011-10	2W 5/8 HOSE JOINER	EA	R34.17
90011-12	2W 3/4 HOSE JOINER	EA	R50.37
90011-16	2W 1 HOSE JOINER	EA	R80.35
90011-20	2W 1 1/4 HOSE JOINER	EA	R152.87
90011-24	2W 1 1/2 HOSE JOINER	EA	R229.57
90011-32	2W 2 HOSE JOINER	EA	R365.10
Blank Tails			
STS-04	1/4 BLANK TAIL	EA	R14.19
STS-05	5/16 BLANK TAIL	EA	R20.76
STS-06	3/8 BLANK TAIL	EA	R22.88
STS-08	1/2 BLANK TAIL	EA	R26.02
STS-10	5/8 BLANK TAIL	EA	R32.84
STS-12	3/4 BLANK TAIL	EA	R63.03
STS-16	1 BLANK TAIL	EA	R95.83
STS-20	1 1/4 BLANK TAIL	EA	R173.92
STS-24	1 1/2 BLANK TAIL	EA	R236.37
STS-32	2 BLANK TAIL	EA	R339.17

